



Industrial Hygiene • Air Quality • Lead & Asbestos • Training • Health & Safety

LIMITED ASBESTOS INSPECTION REPORT

Conducted at:

ENCINITA ELEMENTARY SCHOOL
NE CAMPUS, PLAYGROUNDS, PORTABLES 28 & 29 PROJECT
4515 ENCINITA AVENUE
ROSEMEAD, CALIFORNIA 91770

Prepared for:

DR. MARIA RIOS
ASSISTANT SUPERINTENDENT OF ADMINISTRATIVE SERVICES
ROSEMEAD SCHOOL DISTRICT
3907 ROSEMEAD BOULEVARD, SUITE 220
ROSEMEAD, CALIFORNIA 91770

Prepared by:

EXECUTIVE ENVIRONMENTAL
310 EAST FOOTHILL BOULEVARD, SUITE 200
ARCADIA, CALIFORNIA 91006

Project Number EE 23-Z0046-0029
March 14, 2023

Report assembled by:

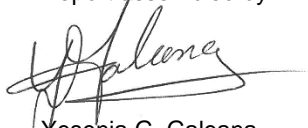
Yesenia G. Galeana
Technical Report Writer
Executive Environmental

Report generated/reviewed by:



Tim Galeana, CAC# 98-2470
Senior Project Manager
Executive Environmental

TABLE OF CONTENTS

- I. EXECUTIVE SUMMARY
- II. SAMPLING METHODOLOGY
- III. SAMPLE ANALYSIS
- IV. FINDINGS
- V. CONCLUSIONS/RECOMMENDATIONS
- VI. DISCLAIMER/REPORT LIMITATIONS

APPENDICES

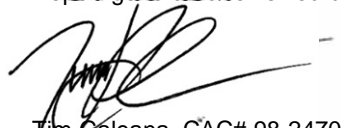
APPENDIX A – LABORATORY ANALYSIS REPORT

APPENDIX B – SAMPLE LOCATION DRAWINGS

APPENDIX C – STAFF CERTIFICATION

LIMITED ASBESTOS INSPECTION REPORT

Project Number: EE 23-Z0046-0029

Client: Rosemead School District
3907 Rosemead Boulevard, Suite 220
Rosemead, California 91770

Site Location: Encinita Elementary School
NE Campus, Playgrounds and Portables 28 & 29 Project
4515 Encinita Avenue
Rosemead, California 91770

Site Use: School Property

Contact Person: Dr. Maria Rios
Assistant Superintendent of Administrative Services
Phone: (626) 312-2900 Ext 219

Inspection Date: February 21, 2023

Inspected By: Mr. Rhys Kuzmic
Certified Asbestos Consultant, # 09-4586

Report Assembled By: Ms. Yesenia G. Galeana
Technical Report Writer

Report Generated/Reviewed By: Mr. Tim Galeana
Certified Asbestos Consultant, # 98-2470

I. EXECUTIVE SUMMARY

Executive Environmental (EE) provided the services of a Certified Asbestos Consultant (Mr. Rhys Kuzmic, CAC no. 09-4586) to conduct a limited asbestos inspection of the Northeast Campus, Playgrounds and Portables 28 & 29 at Encinita Elementary School located at 4515 Encinita Avenue, Rosemead, California. The inspection was conducted as a precursor to the upcoming Renovation Project. Materials suspected of containing asbestos were sampled and analyzed for the presence of asbestos. Assumed Asbestos-Containing Materials (ACM) and other hazardous materials were identified during this inspection. *This is considered to be a limited inspection. Inspection was limited to materials and locations anticipated to be impacted by the Northeast Campus, Playgrounds and Portables 28 & 29 Renovation Project, as directed by client.*

II. SAMPLING METHODOLOGY

A visual inspection of the Northeast Campus, Playgrounds and Portables 28 & 29 was conducted prior to the collection of any bulk samples. The visual inspection was conducted to identify and record the location and condition of the materials to be sampled. Following the visual inspection, bulk material samples of the identified suspect

asbestos-containing building materials were collected. The materials were categorized into homogeneous groupings, and each sample was assigned a unique sample number and placed into a sealed container.

Upon completion of the bulk sample collection, a chain of custody was prepared and the samples were delivered to the laboratory for analysis. AmeriSci of Carson, CA, analyzed the samples using Polarized Light Microscopy (PLM). AmeriSci is an accredited participant in the National Voluntary Laboratory Accreditation Program (NVLAP), No. 200346-0. The principles described in the current Environmental Protection Agency (EPA) 600 method were used in the preparation and analysis of the bulk samples.

Note: Inaccessible suspect asbestos materials may be located within sealed ceilings, walls, or floors; or within wall cavities, interstitials, shafts, etc. Suspect asbestos materials located in these areas must be sampled prior to any activities that might cause them to be disturbed.

III. SAMPLE ANALYSIS

Seventy-six (76) samples were collected during this inspection. The laboratory analysis results are identified in the following table. Materials determined not to contain asbestos are listed as "No Asbestos Detected" (NAD).

Any material found to contain more than 1% of a known asbestos substance is considered to be an asbestos-containing material (ACM). Materials falling within this category are controlled and must be handled in accordance with the California Occupational Safety & Health Administration (Cal/OSHA), EPA, and South Coast Air Quality Management District (SCAQMD) regulations.

In addition, materials which are characterized as non-ACM by EPA or other local regulatory agencies may fall within the regulatory standards of Cal/OSHA, which further regulates any materials found to contain more than 1/10 of 1%, but 1% or less, of a known asbestos substance as asbestos-containing construction materials (ACCMs). Impacting or handling ACCMs requires special employer registration, documentation, training, and personal protective equipment. When a material is to be impacted, the National Emission Standards for Hazardous Air Pollutants (NESHAPs) regulations require further testing for materials that fall within this category.

The PLM analytical protocol requires each layer of the sample to be analyzed separately. The quantity of analyses will vary based on the number of layers in a sample and whether a "positive stop" is employed. When one sample of a homogeneous area is positive, the remainder of the samples need not be analyzed because the entire homogeneous area must be considered positive.

**Sampling results begin on the next page.
The remainder of this page is blank.**

POLARIZED LIGHT MICROSCOPY (PLM) ANALYSIS DATA

Encinita Elementary School
4515 Encinita Avenue
Rosemead, California 91770

| Homogeneous Material # | Material Description | Material Location | Estimated Quantity | Condition ^A | Type ^B | Friable | Percent Damaged | Sample Number | Sample Location | Analytical Results |
|---------------------------------|--|---|--------------------|------------------------|-------------------|---------|-----------------|-----------------|---|--------------------------------|
| Portable P28^C | | | | | | | | | | |
| 1 | Blue sheet flooring and glue (on wood) | Room P28, Restroom 1 and 2 | 920 Square Feet | G | Misc. | Yes | 0 | 2302210029RK-01 | Room P28, southwest | Layers 1 & 2: NAD ^D |
| | | | | | | | | 2302210029RK-02 | Restroom 2, north | Layers 1 & 2: NAD |
| | | | | | | | | 2302210029RK-03 | Restroom 1, northwest | Layers 1 & 2: NAD |
| 2 | Vinyl baseboard adhesive | Walls and cabinets of Room P28, Restroom 1 and 2 | 160 Linear Feet | G | Misc. | No | 0 | 2302210029RK-04 | Room P28, south wall | NAD |
| | | | | | | | | 2302210029RK-05 | Restroom 2, north wall | NAD |
| | | | | | | | | 2302210029RK-06 | North wall of Restroom 1 at sink area | NAD |
| 3 | FRP adhesive (on drywall) | Walls of Restrooms 1 and 2 | 500 Square Feet | G | Misc. | No | 0 | 2302210029RK-07 | Restroom 2, west wall | NAD |
| | | | | | | | | 2302210029RK-08 | Restroom 1, west wall | NAD |
| | | | | | | | | 2302210029RK-09 | Restroom 1, west wall | NAD |
| 4 | Drywall with fiberboard adhesive (no joint compound) | Behind fiberboard walls of Room P28 Behind FRP of Restrooms 1 and 2 | 1,600 Square Feet | G | Misc. | Yes | 0 | 2302210029RK-10 | Room P28, north wall, above drop ceiling | NAD |
| | | | | | | | | 2302210029RK-11 | Room P28, south wall, above drop ceiling | NAD |
| | | | | | | | | 2302210029RK-12 | Restroom 2, east wall, above drop ceiling | NAD |

Note: This table must be used in conjunction with the entire report. This document is not to be used for contract bidding and is intended to be used to identify asbestos-containing materials and their locations only.

Sampling results begin on the next page.

^A G = Good; D = Damaged; SD = Severely Damaged

^B Misc. = Miscellaneous; Surf. = Surfacing; TSI = Thermal System Insulation

^C NOTE: 1) Fiberglass insulation above drop ceilings and in wall cavities. 2) Fiberboard walls. 3) Metal roofs. 4) No window putty identified.

^D NAD = No Asbestos Detected.

POLARIZED LIGHT MICROSCOPY (PLM) ANALYSIS DATA

Encinita Elementary School
4515 Encinita Avenue
Rosemead, California 91770

| Homogeneous Material # | Material Description | Material Location | Estimated Quantity | Condition ^E | Type ^F | Friable | Percent Damaged | Sample Number | Sample Location | Analytical Results |
|------------------------|---|--|--------------------|------------------------|-------------------|---------|-----------------|-----------------|--------------------------------|--------------------|
| Portable P28 | | | | | | | | | | |
| 5 | 2'x4' Fissured ceiling panel (suspended, no glue) | Room P28, Restroom 1 and 2 | 920 Square Feet | G | Misc. | Yes | 0 | 2302210029RK-13 | Room P28, northwest | NAD ^G |
| | | | | | | | | 2302210029RK-14 | Room P28, southwest | NAD |
| | | | | | | | | 2302210029RK-15 | Restroom 2, west | NAD |
| 6 | Caulking/mastic with coating | Throughout rooftop on metal, roof jacks and caulking on gutter | 1,000 Square Feet | G | Misc. | No | 0 | 2302210029RK-16 | Northeast at penetration screw | NAD |
| | | | | | | | | 2302210029RK-17 | East at roof jack | NAD |
| | | | | | | | | 2302210029RK-18 | North at penetration screw | NAD |
| | | | | | | | | 2302210029RK-19 | Northeast at gutter | NAD |
| 7 | Caulking | At sinks and toilets of Restroom 1 and 2 | 1 Square Feet | G | Misc. | No | 0 | 2302210029RK-20 | Restroom 1, at sink | NAD |
| | | | | | | | | 2302210029RK-21 | Restroom 1, at toilet | NAD |
| | | | | | | | | 2302210029RK-22 | Restroom 2, at sink | NAD |
| 8 | Concrete | Room P28 ramp | 300 Square Feet | G | Misc. | No | 0 | 2302220037RK-41 | East | NAD |
| | | | | | | | | 2302220037RK-42 | Northeast | NAD |
| | | | | | | | | 2302220037RK-43 | Northwest | NAD |
| 9 | Fire-rated door | Restrooms 1 and 2 | 2 Total | G | Misc. | Yes | 0 | --- | --- | Assumed |

Note: This table must be used in conjunction with the entire report. This document is not to be used for contract bidding and is intended to be used to identify asbestos-containing materials and their locations only.

Sampling results begin on the next page

^E G = Good; D = Damaged; SD = Severely Damaged

^F Misc. = Miscellaneous; Surf. = Surfacing; TSI = Thermal System Insulation

^G NAD = No Asbestos Detected.

POLARIZED LIGHT MICROSCOPY (PLM) ANALYSIS DATA

Encinita Elementary School
4515 Encinita Avenue
Rosemead, California 91770

| Homogeneous Material # | Material Description | Material Location | Estimated Quantity | Condition ^H | Type ^I | Friable | Percent Damaged | Sample Number | Sample Location | Analytical Results |
|---------------------------------|--|-------------------------------------|--------------------|------------------------|-------------------|---------|-----------------|-----------------|--------------------------------|--------------------|
| Portable P29^J | | | | | | | | | | |
| 10 | Carpet glue (on wood) | Room P29 | 920 Square Feet | G | Misc. | No | 0 | 2302210029RK-23 | Northeast | NAD ^K |
| | | | | | | | | 2302210029RK-24 | Southeast | NAD |
| | | | | | | | | 2302210029RK-25 | Northwest | NAD |
| 11 | Vinyl baseboard adhesive | Room P29 | 120 Linear Feet | G | Misc. | No | 0 | 2302210029RK-26 | East wall | NAD |
| | | | | | | | | 2302210029RK-27 | North wall | NAD |
| | | | | | | | | 2302210029RK-28 | South wall | NAD |
| 12 | Drywall with fiberboard adhesive (no joint compound) | Behind fiberboard walls of Room P29 | 1,200 Square Feet | G | Misc. | Yes | 0 | 2302210029RK-29 | West wall, above drop ceiling | NAD |
| | | | | | | | | 2302210029RK-30 | East wall, above drop ceiling | NAD |
| | | | | | | | | 2302210029RK-31 | South wall, above drop ceiling | NAD |
| 13 | 2'x4' Fissured ceiling panel (suspended, no glue) | Room P29 | 920 Square Feet | G | Misc. | Yes | 0 | 2302210029RK-32 | Northwest | NAD |
| | | | | | | | | 2302210029RK-33 | Northeast | NAD |
| | | | | | | | | 2302220037RK-34 | South | NAD |

Note: This table must be used in conjunction with the entire report. This document is not to be used for contract bidding and is intended to be used to identify asbestos-containing materials and their locations only.

Sampling results begin on the next page

^H G = Good; D = Damaged; SD = Severely Damaged

^I Misc. = Miscellaneous; Surf. = Surfacing; TSI = Thermal System Insulation

^J NOTE: 1) Fiberglass insulation above drop ceilings and in wall cavities. 2) Fiberboard walls. 3) Metal roofs. 4) No window putty identified. 5) No fire-rated doors in P29.

^K NAD = No Asbestos Detected.

POLARIZED LIGHT MICROSCOPY (PLM) ANALYSIS DATA

Encinita Elementary School
4515 Encinita Avenue
Rosemead, California 91770

| Homogeneous Material # | Material Description | Material Location | Estimated Quantity | Condition ^L | Type ^M | Friable | Percent Damaged | Sample Number | Sample Location | Analytical Results |
|------------------------|-------------------------------------|---|-------------------------|------------------------|-------------------|---------|-----------------|-----------------|-----------------------------------|--------------------|
| Portable P29 | | | | | | | | | | |
| 14 | Caulking/ mastic with coating | Throughput metal rooftop and gutters | 1,000 Square Feet | G | Misc. | No | 0 | 2302210029RK-35 | Southeast at gutter | NAD ^N |
| | | | | | | | | 2302210029RK-36 | Southwest at penetration screw | NAD |
| | | | | | | | | 2302210029RK-37 | Northwest at penetration screw | NAD |
| 15 | Coating | On wood ramp of Room P29 | 90 Square Feet | G | Surf. | No | <1 | 2302210029RK-38 | North | NAD |
| | | | | | | | | 2302210029RK-39 | North | NAD |
| | | | | | | | | 2302210029RK-40 | North | NAD |

Note: This table must be used in conjunction with the entire report. This document is not to be used for contract bidding and is intended to be used to identify asbestos-containing materials and their locations only.

Sampling results begin on the next page

^L G = Good; D = Damaged; SD = Severely Damaged

^M Misc. = Miscellaneous; Surf. = Surfacing; TSI = Thermal System Insulation

^N NAD = No Asbestos Detected.

POLARIZED LIGHT MICROSCOPY (PLM) ANALYSIS DATA

Encinita Elementary School
4515 Encinita Avenue
Rosemead, California 91770

| Homogeneous Material # | Material Description | Material Location | Estimated Quantity | Condition ^o | Type ^p | Friable | Percent Damaged | Sample Number | Sample Location | Analytical Results |
|---------------------------|----------------------|--|--------------------|------------------------|-------------------|---------|-----------------|-----------------|-----------------------------------|--------------------|
| Campus^q | | | | | | | | | | |
| 16 | Asphalt paving | Area 1: (Area surrounding Portables P28 & P29) | 3,500 Square Feet | G | Misc. | No | 0 | 2302220029RK-44 | Southeast | NAD ^R |
| | | | | | | | | 2302220029RK-45 | Southwest | NAD |
| | | | | | | | | 2302220029RK-46 | Northwest | NAD |
| | | | | | | | | 2302220029RK-47 | North between Portables P28 & P29 | NAD |
| | | | | | | | | 2302220029RK-48 | Northeast | NAD |
| 17 | Concrete footing | Area 1: South at fence footing (Area surrounding Portables P28 & P29) | 12 Square Feet | G | Misc. | No | 0 | 2302220029RK-49 | Southeast | NAD |
| | | | | | | | | 2302220029RK-50 | South | NAD |
| | | | | | | | | 2302220029RK-51 | Southwest | NAD |
| 18 | Concrete | Area 1: Walkway between Portables P26 & P27 (Area surrounding Portables P28 & P29) | 150 Square Feet | G | Misc. | No | 0 | 2302220029RK-52 | Southwest of P27 on walkway | NAD |
| | | | | | | | | 2302220029RK-53 | West of P27 on walkway | NAD |
| | | | | | | | | 2302220029RK-54 | East of P26 on walkway | NAD |

Note: This table must be used in conjunction with the entire report. This document is not to be used for contract bidding and is intended to be used to identify asbestos-containing materials and their locations only.

Sampling results begin on the next page

^o G = Good; D = Damaged; SD = Severely Damaged

^p Misc. = Miscellaneous; Surf. = Surfacing; TSI = Thermal System Insulation

^q NOTE: 1) Wood chips at base of Areas 4 and 5 Playgrounds.

^R NAD = No Asbestos Detected.

POLARIZED LIGHT MICROSCOPY (PLM) ANALYSIS DATA

Encinita Elementary School
4515 Encinita Avenue
Rosemead, California 91770

| Homogeneous Material # | Material Description | Material Location | Estimated Quantity | Condition ^s | Type ^T | Friable | Percent Damaged | Sample Number | Sample Location | Analytical Results |
|------------------------|----------------------|---|-----------------------|------------------------|-------------------|---------|-----------------|-----------------|--|--------------------|
| Campus | | | | | | | | | | |
| 19 | Concrete | Area 2: Walkway and curb (Area northwest of Building C MPR) | 100 Square Feet | G | Misc. | No | 0 | 2302220029RK-55 | North at curb | NAD ^U |
| | | | | | | | | 2302220029RK-56 | North at walkway | NAD |
| | | | | | | | | 2302220029RK-57 | Northeast walkway | NAD |
| 20 | Asphalt paving | Area 2: (Area northwest of Building C MPR) | 250 Square Feet | G | Misc. | No | <1 | 2302220029RK-58 | North | NAD |
| | | | | | | | | 2302220029RK-59 | Southeast | NAD |
| | | | | | | | | 2302220029RK-60 | South | NAD |
| 21 | Concrete | Area 3: Walkway (Area between Restroom Building and Staff Restroom Building) | 200 Square Feet | G | Misc. | No | 0 | 2302220029RK-61 | Southwest | NAD |
| | | | | | | | | 2302220029RK-62 | Northwest | NAD |
| | | | | | | | | 2302220029RK-63 | North | NAD |
| 22 | Concrete curb | Area 4: Southwest Playground (at perimeter of playground) | 320 Square Feet | G | Misc. | No | <1 | 2302220029RK-64 | Southeast | NAD |
| | | | | | | | | 2302220029RK-65 | Northeast | NAD |
| | | | | | | | | 2302220029RK-66 | Southwest at perimeter of playground curb | NAD |

Note: This table must be used in conjunction with the entire report. This document is not to be used for contract bidding and is intended to be used to identify asbestos-containing materials and their locations only.

Sampling results begin on the next page

^s G = Good; D = Damaged; SD = Severely Damaged

^T Misc. = Miscellaneous; Surf. = Surfacing; TSI = Thermal System Insulation

^U NAD = No Asbestos Detected.

POLARIZED LIGHT MICROSCOPY (PLM) ANALYSIS DATA

Encinita Elementary School
4515 Encinita Avenue
Rosemead, California 91770

| Homogeneous Material # | Material Description | Material Location | Estimated Quantity | Condition ^v | Type ^w | Friable | Percent Damaged | Sample Number | Sample Location | Analytical Results |
|------------------------|---------------------------|---|--------------------|------------------------|-------------------|---------|-----------------|-----------------|--|--------------------|
| Campus | | | | | | | | | | |
| 23 | Asphalt paving | Area 4: Southwest Playground (Paving north of playground) | 500 Square Feet | G | Misc. | No | 0 | 2302220029RK-67 | Northeast | NAD ^x |
| | | | | | | | | 2302220029RK-68 | North | NAD |
| | | | | | | | | 2302220029RK-69 | Northwest | NAD |
| 24 | Concrete walkway and curb | Area 5: Playground (North of Building H Classrooms 19 & 20) | 980 Square Feet | G | Misc. | No | 0 | 2302220029RK-70 | North at walkway to main entry of campus | NAD |
| | | | | | | | | 2302220029RK-71 | North at walkway to playground entry | NAD |
| | | | | | | | | 2302220029RK-72 | Walkway west of playground | NAD |
| | | | | | | | | 2302220029RK-73 | Curb at southwest section of playground | NAD |
| 25 | Asphalt paving | Area 5: Playground (North of Building H Classrooms 19 & 20) | 500 Square Feet | G | Misc. | No | 0 | 2302220029RK-74 | West of playground | NAD |
| | | | | | | | | 2302220029RK-75 | West of playground | NAD |
| | | | | | | | | 2302220029RK-76 | Southwest playground | NAD |

Note: This table must be used in conjunction with the entire report. This document is not to be used for contract bidding and is intended to be used to identify asbestos-containing materials and their locations only.

The remainder of this page is blank.

^v G = Good; D = Damaged; SD = Severely Damaged

^w Misc. = Miscellaneous; Surf. = Surfacing; TSI = Thermal System Insulation

^x NAD = No Asbestos Detected.

| HAZARDOUS MATERIALS Encinita Elementary School 4515 Encinita Avenue Rosemead, California 91770 | | | |
|--|--|-----------------------------|-------------------|
| Homogeneous Material # | Material Description | Material Location | Estimate Quantity |
| Portable P28 | | | |
| 26 | PCB-containing light ballasts (assumed) | Room P28, Restrooms 1 and 2 | 12 Total |
| 27 | Mercury-containing fluorescent light tubes/bulbs (assumed) | Room P28, Restrooms 1 and 2 | 24 Total |
| 28 | Freon-containing HVAC units (assumed) | Exterior south wall | 1 Total |
| Portable P29 | | | |
| 29 | PCB-containing light ballasts (assumed) | Room P29 | 12 Total |
| 30 | Mercury-containing fluorescent light tubes/bulbs (assumed) | Room P29 | 24 Total |
| 31 | Freon-containing HVAC units (assumed) | Exterior south wall | 1 Total |

Note: This table must be used in conjunction with the entire report. This document is not to be used for contract bidding and is intended to be used to identify other hazardous materials and their locations only.

IV. FINDINGS

EE conducted a limited asbestos inspection of the Northeast Campus, Playgrounds and Portables 28 & 29 at Encinita Elementary School located at 4515 Encinita Avenue, Rosemead, California.

Thirty-one (31) homogeneous material groups were identified during the visual property inspection. Seventy-six (76) samples of suspect asbestos-containing materials were collected and delivered to AmeriSci of Carson, CA for analysis. The homogeneous area and sampling results are listed on the table in Section III.

The analytical data revealed that the following materials contain asbestos or other hazardous material:

Portables:

- **Fire-rated doors:** The fire-rated doors located at Portable P28: Restrooms 1 and 2 are presumed asbestos content.
- **PCB-containing Ballast:** The light ballast located Portables P28 & P29 the light fixtures are assumed to be PCB-containing.

Portables (continued):

- Mercury-containing Fluorescent Light Tubes: The fluorescent light tubes located throughout Portables P28 & P29 are assumed to be mercury containing.
- Freon-containing HVAC units: The HVAC units located at exterior south walls of Portables P28 & P29 are assumed to contain Freon.

V. CONCLUSIONS/RECOMMENDATIONS

Normally, asbestos-containing material found to be in good condition is not considered a hazard, unless it is disturbed. Prior to the start of any activity, such as remodeling, demolition, or renovation that might disturb these materials, a Certified Asbestos Consultant should be contracted to design and monitor the project. A California-licensed asbestos contractor should be hired to complete the asbestos abatement procedures.

If you have any questions, please call Mr. Tim Galeana at 626-441-7050. We are glad we could be of service to you.

VI. DISCLAIMER/REPORT LIMITATIONS

All reports and recommendations are based on conditions and practices observed and information made available to Executive Environmental (EE) by the client and the designated sites/facilities on the days sampling was conducted. This report does not purport to set forth all hazards, nor to indicate that other hazards do not exist. No responsibility is assumed by EE for the control or correction of conditions or practices existing at the facilities, or at any other premises surveyed by EE, for and on the behalf of the client. Services provided by EE shall be governed by the standard of practice for professional services measured at the time those services are rendered.

All information contained in this report is proprietary and limited to the scope of services, parameters of the analytical methods used and the conditions present at the time of this inspection. Any references to quantities are considered estimates and are not to be construed as actual.

APPENDIX A – LABORATORY ANALYSIS REPORT



Please Reply To:

AmeriSci Los Angeles

24416 S. Main Street, Ste 308
Carson, California 90745
TEL: (310) 834-4868 • FAX: (310) 834-4772

LABORATORY ELECTRONIC TRANSMITTAL

| | |
|---|--|
| To: Yesenia Galeana Executive Environmental Services Corporatio | From: Rosa E. Pena |
| Fax #: | AmeriSci Job #: 923021478 |
| | Subject: PLM 3 day Results |
| Email: info@execenv.com, ygaleana@execenv.com | Client Project: 23-Z0046-0029; P28 & P29 & Ramps, Campus |

Date: Tuesday, February 28, 2023
Time: 12:44:49
Comments:

Number of Pages: _____
(including cover sheet)

NOTE: Attached report is to be considered preliminary until final review with accompanying analysis summary letter is issued.

CONFIDENTIALITY NOTICE: Unless otherwise indicated, the information contained in this communication is confidential information intended for use of the individual named above. If the reader of this communication is not the intended recipient, you are hereby notified that any dissemination, distribution or copying of this communication is prohibited. If you have received this communication in error, please immediately notify the sender by telephone and return the original message to the above address via the US Postal Service at our expense. Samples are disposed of in 60 days or unless otherwise instructed by the protocol or special instructions in writing. Thank you.

Certified Analysis Service 24 Hours A Day • 7 Days A Week Competitive Prices
visit our web site - www.amerisci.com

Boston • Los Angeles • New York • Richmond

**AmeriSci Los Angeles**

24416 S. Main Street, Ste 308

Carson, California 90745

TEL: (310) 834-4868 • FAX: (310) 834-4772

PLM Bulk Asbestos Report

Executive Environmental Services Corporation
Attn: Yesenia Galeana
310 East Foothill Blvd.
Suite 200
Arcadia, CA 91006

Date Received 02/24/23
Date Examined 02/25/23
AmeriSci Job # 923021478
P.O. #
Page 1 **of** 14
RE: 23-Z0046-0029; P28 & P29 & Ramps, Campus

| Client No. / HGA | Lab No. | Asbestos Present | Total % Asbestos |
|--|----------------|------------------|---|
| 2302210029RK-01 | 923021478-01L1 | No | NAD |
| Location: P28, SW / Blue Sheet Flooring And Glue (On Wood) / P28, Restroom 1, Restroom 2 Floor | | | (by CVES) by Rosa E. Pena on 02/25/23 |
| Analyst Description: Blue, Homogeneous, Fibrous, Sheet Flooring Asbestos Types: Other Material: Synthetic fibers 15%, Non-fibrous 85% | | | |
| 2302210029RK-01 | 923021478-01L2 | No | NAD |
| Location: P28, SW / Blue Sheet Flooring And Glue (On Wood) / P28, Restroom 1, Restroom 2 Floor | | | (by CVES) by Rosa E. Pena on 02/25/23 |
| Analyst Description: Tan, Heterogeneous, Non-Fibrous, Glue Asbestos Types: Other Material: Non-fibrous 100% | | | |
| 2302210029RK-02 | 923021478-02L1 | No | NAD |
| Location: Restroom 2, North / Blue Sheet Flooring And Glue (On Wood) | | | (by CVES) by Rosa E. Pena on 02/25/23 |
| Analyst Description: Blue, Homogeneous, Fibrous, Sheet Flooring Asbestos Types: Other Material: Synthetic fibers 15%, Non-fibrous 85% | | | |
| 2302210029RK-02 | 923021478-02L2 | No | NAD |
| Location: Restroom 2, North / Blue Sheet Flooring And Glue (On Wood) | | | (by CVES) by Rosa E. Pena on 02/25/23 |
| Analyst Description: Tan, Homogeneous, Non-Fibrous, Glue Asbestos Types: Other Material: Non-fibrous 100% | | | |
| 2302210029RK-03 | 923021478-03L1 | No | NAD |
| Location: Restroom 1, NW / Blue Sheet Flooring And Glue (On Wood) | | | (by CVES) by Rosa E. Pena on 02/25/23 |
| Analyst Description: Blue, Homogeneous, Fibrous, Sheet Flooring Asbestos Types: Other Material: Synthetic fibers 15%, Non-fibrous 85% | | | |

PLM Bulk Asbestos Report

23-Z0046-0029; P28 & P29 & Ramps, Campus

| Client No. / HGA | Lab No. | Asbestos Present | Total % Asbestos |
|--|----------------|-------------------------|---|
| 2302210029RK-03 | 923021478-03L2 | No | NAD |
| Location: Restroom 1, NW / Blue Sheet Flooring And Glue (On Wood) | | | (by CVES) by Rosa E. Pena on 02/25/23 |
| Analyst Description: Tan, Homogeneous, Non-Fibrous, Glue | | | |
| Asbestos Types: | | | |
| Other Material: Non-fibrous 100% | | | |
| 2302210029RK-04 | 923021478-04 | No | NAD |
| Location: P28, South Wall / Vinyl Baseboard Adhesive / P28, Restroom 1, Restroom 2 Walls And Cabinets | | | (by CVES) by Rosa E. Pena on 02/26/23 |
| Analyst Description: Beige, Homogeneous, Non-Fibrous, Adhesive | | | |
| Asbestos Types: | | | |
| Other Material: Non-fibrous 100% | | | |
| 2302210029RK-05 | 923021478-05 | No | NAD |
| Location: Restroom 2, North Wall / Vinyl Baseboard Adhesive | | | (by CVES) by Rosa E. Pena on 02/26/23 |
| Analyst Description: Black/Beige, Heterogeneous, Non-Fibrous, Adhesive | | | |
| Asbestos Types: | | | |
| Other Material: Non-fibrous 100% | | | |
| 2302210029RK-06 | 923021478-06 | No | NAD |
| Location: P28, North Wall Of Restroom 1 At Sink Cabinet / Vinyl Baseboard Adhesive | | | (by CVES) by Rosa E. Pena on 02/26/23 |
| Analyst Description: Cream, Homogeneous, Non-Fibrous, Adhesive | | | |
| Asbestos Types: | | | |
| Other Material: Non-fibrous 100% | | | |
| 2302210029RK-07 | 923021478-07 | No | NAD |
| Location: Restroom 2, West Wall / FRP Adhesive (On Drywall) / Restroom 1, Restroom 2 Walls | | | (by CVES) by Rosa E. Pena on 02/26/23 |
| Analyst Description: Tan, Homogeneous, Non-Fibrous, Adhesive | | | |
| Asbestos Types: | | | |
| Other Material: Non-fibrous 100% | | | |
| 2302210029RK-08 | 923021478-08 | No | NAD |
| Location: Restroom 1, West Wall / FRP Adhesive (On Drywall) | | | (by CVES) by Rosa E. Pena on 02/26/23 |
| Analyst Description: Tan, Homogeneous, Non-Fibrous, Adhesive | | | |
| Asbestos Types: | | | |
| Other Material: Non-fibrous 100% | | | |

PLM Bulk Asbestos Report

23-Z0046-0029; P28 & P29 & Ramps, Campus

| Client No. / HGA | Lab No. | Asbestos Present | Total % Asbestos |
|---|----------------|-------------------------|---|
| 2302210029RK-09 | 923021478-09 | No | NAD |
| Location: Restroom 1, West Wall / FRP Adhesive (On Drywall) | | | (by CVES) by Rosa E. Pena on 02/26/23 |
| Analyst Description: Tan, Homogeneous, Non-Fibrous, Adhesive | | | |
| Asbestos Types: | | | |
| Other Material: Non-fibrous 100% | | | |
| 2302210029RK-10 | 923021478-10 | No | NAD |
| Location: P28, North Wall Above Drop Ceiling / Drywall, No Joint Compound (Behind Fiberboard And FRP) With Fiberboard Adhesive / P28 Behind Fiberboard Walls, Restroom 1 And Restroom 2 Behind FRP | | | (by CVES) by Rosa E. Pena on 02/26/23 |
| Analyst Description: White/Brown, Heterogeneous, Fibrous, Drywall | | | |
| Asbestos Types: | | | |
| Other Material: Cellulose 12%, Non-fibrous 88% | | | |
| 2302210029RK-11 | 923021478-11 | No | NAD |
| Location: P28, South Wall Above Drop Ceiling / Drywall, No Joint Compound (Behind Fiberboard And FRP) With Fiberboard Adhesive | | | (by CVES) by Rosa E. Pena on 02/26/23 |
| Analyst Description: White/Brown, Heterogeneous, Fibrous, Drywall | | | |
| Asbestos Types: | | | |
| Other Material: Cellulose 12%, Non-fibrous 88% | | | |
| 2302210029RK-12 | 923021478-12 | No | NAD |
| Location: Restroom 2, East Wall Above Drop Ceiling / Drywall, No Joint Compound (Behind Fiberboard And FRP) With Fiberboard Adhesive | | | (by CVES) by Rosa E. Pena on 02/26/23 |
| Analyst Description: White/Brown, Heterogeneous, Fibrous, Drywall | | | |
| Asbestos Types: | | | |
| Other Material: Cellulose 12%, Non-fibrous 88% | | | |
| 2302210029RK-13 | 923021478-13 | No | NAD |
| Location: P28, NW / 2 x 4 Fissured Ceiling Panel Suspended - No Glue / P28, Restroom 1, Restroom 2 Ceilings | | | (by CVES) by Rosa E. Pena on 02/26/23 |
| Analyst Description: White/Gray, Homogeneous, Fibrous, Ceiling Panel | | | |
| Asbestos Types: | | | |
| Other Material: Cellulose 25%, Fibrous glass 10%, Non-fibrous 65% | | | |
| 2302210029RK-14 | 923021478-14 | No | NAD |
| Location: P28, SW / 2 x 4 Fissured Ceiling Panel Suspended - No Glue | | | (by CVES) by Rosa E. Pena on 02/26/23 |
| Analyst Description: White/Gray, Homogeneous, Fibrous, Ceiling Panel | | | |
| Asbestos Types: | | | |
| Other Material: Cellulose 25%, Fibrous glass 10%, Non-fibrous 65% | | | |

PLM Bulk Asbestos Report

23-Z0046-0029; P28 & P29 & Ramps, Campus

| Client No. / HGA | Lab No. | Asbestos Present | Total % Asbestos |
|---|--------------|------------------|---|
| 2302210029RK-15 | 923021478-15 | No | NAD |
| Location: Restroom 2, West / 2 x 4 Fissured Ceiling Panel Suspended - No Glue | | | (by CVES) by Rosa E. Pena on 02/26/23 |
| Analyst Description: White/Gray, Homogeneous, Fibrous, Ceiling Panel | | | |
| Asbestos Types: | | | |
| Other Material: Cellulose 25%, Fibrous glass 10%, Non-fibrous 65% | | | |
| 2302210029RK-16 | 923021478-16 | No | NAD |
| Location: P28 Roof, NE At Penetration Screw / Caulking / Mastic With Coating / P28 T-O Roof On Metal And Caulking On Gutters | | | (by CVES) by Rosa E. Pena on 02/26/23 |
| Analyst Description: White, Homogeneous, Fibrous, Caulking | | | |
| Asbestos Types: | | | |
| Other Material: Synthetic fibers 10%, Non-fibrous 90% | | | |
| 2302210029RK-17 | 923021478-17 | No | NAD |
| Location: P28 Roof, East At Roof Jack / Caulking / Mastic With Coating | | | (by CVES) by Rosa E. Pena on 02/26/23 |
| Analyst Description: White/Black, Heterogeneous, Non-Fibrous, Caulking | | | |
| Asbestos Types: | | | |
| Other Material: Cellulose 2%, Non-fibrous 98% | | | |
| 2302210029RK-18 | 923021478-18 | No | NAD |
| Location: P28 Roof, North At Penetration Screw / Caulking / Mastic With Coating | | | (by CVES) by Rosa E. Pena on 02/26/23 |
| Analyst Description: White, Homogeneous, Non-Fibrous, Caulking | | | |
| Asbestos Types: | | | |
| Other Material: Non-fibrous 100% | | | |
| 2302210029RK-19 | 923021478-19 | No | NAD |
| Location: P28 Roof, NE At Gutter / Caulking / Mastic With Coating | | | (by CVES) by Rosa E. Pena on 02/26/23 |
| Analyst Description: White, Homogeneous, Non-Fibrous, Caulking | | | |
| Asbestos Types: | | | |
| Other Material: Non-fibrous 100% | | | |
| 2302210029RK-20 | 923021478-20 | No | NAD |
| Location: P28: Restroom 1 At Sink / Caulking / P28: Restrooms 1 And 2 At Sinks And Toilets | | | (by CVES) by Rosa E. Pena on 02/26/23 |
| Analyst Description: Off-White, Homogeneous, Non-Fibrous, Caulking | | | |
| Asbestos Types: | | | |
| Other Material: Non-fibrous 100% | | | |

PLM Bulk Asbestos Report

23-Z0046-0029; P28 & P29 & Ramps, Campus

| Client No. / HGA | Lab No. | Asbestos Present | Total % Asbestos |
|---|--------------|------------------|---|
| 2302210029RK-21 | 923021478-21 | No | NAD |
| Location: P28: Restroom 1 At Toilet / Caulking | | | (by CVES) by Rosa E. Pena on 02/26/23 |
| Analyst Description: Off-White, Homogeneous, Non-Fibrous, Caulking | | | |
| Asbestos Types: | | | |
| Other Material: Non-fibrous 100% | | | |
| 2302210029RK-22 | 923021478-22 | No | NAD |
| Location: P28: Restroom 2 At Sink / Caulking | | | (by CVES) by Rosa E. Pena on 02/26/23 |
| Analyst Description: Off-White, Homogeneous, Non-Fibrous, Caulking | | | |
| Asbestos Types: | | | |
| Other Material: Non-fibrous 100% | | | |
| 2302210029RK-23 | 923021478-23 | No | NAD |
| Location: P29, NE / Carpet Glue (On Wood) / P29 Floor | | | (by CVES) by Rosa E. Pena on 02/26/23 |
| Analyst Description: Tan, Homogeneous, Non-Fibrous, Carpet Glue | | | |
| Asbestos Types: | | | |
| Other Material: Non-fibrous 100% | | | |
| 2302210029RK-24 | 923021478-24 | No | NAD |
| Location: P29, SE / Carpet Glue (On Wood) | | | (by CVES) by Rosa E. Pena on 02/26/23 |
| Analyst Description: Tan, Homogeneous, Non-Fibrous, Carpet Glue | | | |
| Asbestos Types: | | | |
| Other Material: Non-fibrous 100% | | | |
| 2302210029RK-25 | 923021478-25 | No | NAD |
| Location: P29, NW / Carpet Glue (On Wood) | | | (by CVES) by Rosa E. Pena on 02/26/23 |
| Analyst Description: Tan, Homogeneous, Non-Fibrous, Carpet Glue | | | |
| Asbestos Types: | | | |
| Other Material: Cellulose 2%, Non-fibrous 98% | | | |
| 2302210029RK-26 | 923021478-26 | No | NAD |
| Location: P29, East Wall / Vinyl Baseboard Adhesive / P29 Walls | | | (by CVES) by Rosa E. Pena on 02/26/23 |
| Analyst Description: Off-White, Homogeneous, Non-Fibrous, Adhesive | | | |
| Asbestos Types: | | | |
| Other Material: Non-fibrous 100% | | | |

PLM Bulk Asbestos Report

23-Z0046-0029; P28 & P29 & Ramps, Campus

| Client No. / HGA | Lab No. | Asbestos Present | Total % Asbestos |
|---|--------------|------------------|---|
| 2302210029RK-27 | 923021478-27 | No | NAD |
| Location: P29, North Wall / Vinyl Baseboard Adhesive | | | (by CVES) by Rosa E. Pena on 02/26/23 |
| Analyst Description: Off-White, Homogeneous, Non-Fibrous, Adhesive | | | |
| Asbestos Types: | | | |
| Other Material: Non-fibrous 100% | | | |
| 2302210029RK-28 | 923021478-28 | No | NAD |
| Location: P29, South Wall / Vinyl Baseboard Adhesive | | | (by CVES) by Rosa E. Pena on 02/26/23 |
| Analyst Description: Off-White, Homogeneous, Non-Fibrous, Adhesive | | | |
| Asbestos Types: | | | |
| Other Material: Non-fibrous 100% | | | |
| 2302210029RK-29 | 923021478-29 | No | NAD |
| Location: P29, West Wall Above Drop Ceiling / Drywall No Joint Compound (Behind Fiberboard) With Fiberboard Adhesive / P29 Walls Behind Fiberboard | | | (by CVES) by Rosa E. Pena on 02/26/23 |
| Analyst Description: White/Brown, Heterogeneous, Fibrous, Drywall | | | |
| Asbestos Types: | | | |
| Other Material: Cellulose 12%, Non-fibrous 88% | | | |
| 2302210029RK-30 | 923021478-30 | No | NAD |
| Location: P29, East Wall Above Drop Ceiling / Drywall No Joint Compound (Behind Fiberboard) With Fiberboard Adhesive | | | (by CVES) by Rosa E. Pena on 02/26/23 |
| Analyst Description: White/Brown, Heterogeneous, Fibrous, Drywall | | | |
| Asbestos Types: | | | |
| Other Material: Cellulose 12%, Non-fibrous 88% | | | |
| 2302210029RK-31 | 923021478-31 | No | NAD |
| Location: P29, South Wall Above Drop Ceiling / Drywall No Joint Compound (Behind Fiberboard) With Fiberboard Adhesive | | | (by CVES) by Rosa E. Pena on 02/26/23 |
| Analyst Description: White/Brown, Heterogeneous, Fibrous, Drywall | | | |
| Asbestos Types: | | | |
| Other Material: Cellulose 12%, Non-fibrous 88% | | | |
| 2302210029RK-32 | 923021478-32 | No | NAD |
| Location: P29, NW / 2 x 4 Fissured Ceiling Panel Suspended - No Glue / P29 Ceiling | | | (by CVES) by Rosa E. Pena on 02/26/23 |
| Analyst Description: White/Gray, Homogeneous, Fibrous, Ceiling Panel | | | |
| Asbestos Types: | | | |
| Other Material: Cellulose 25%, Fibrous glass 10%, Non-fibrous 65% | | | |

PLM Bulk Asbestos Report

23-Z0046-0029; P28 & P29 & Ramps, Campus

| Client No. / HGA | Lab No. | Asbestos Present | Total % Asbestos |
|---|--------------|------------------|---|
| 2302210029RK-33 | 923021478-33 | No | NAD |
| Location: P29, NE / 2 x 4 Fissured Ceiling Panel Suspended - No Glue | | | (by CVES) by Rosa E. Pena on 02/26/23 |
| Analyst Description: White/Gray, Homogeneous, Fibrous, Ceiling Panel | | | |
| Asbestos Types: | | | |
| Other Material: Cellulose 25%, Fibrous glass 10%, Non-fibrous 65% | | | |
| 2302210029RK-34 | 923021478-34 | No | NAD |
| Location: P29, South / 2 x 4 Fissured Ceiling Panel Suspended - No Glue | | | (by CVES) by Rosa E. Pena on 02/26/23 |
| Analyst Description: White/Gray, Homogeneous, Fibrous, Ceiling Panel | | | |
| Asbestos Types: | | | |
| Other Material: Cellulose 25%, Fibrous glass 10%, Non-fibrous 65% | | | |
| 2302210029RK-35 | 923021478-35 | No | NAD |
| Location: P29 Roof, SE At Gutter / Caulking / Mastic With Coating / P29 T-O Metal Roof And Gutters | | | (by CVES) by Rosa E. Pena on 02/26/23 |
| Analyst Description: White, Homogeneous, Non-Fibrous, Caulking | | | |
| Asbestos Types: | | | |
| Other Material: Non-fibrous 100% | | | |
| 2302210029RK-36 | 923021478-36 | No | NAD |
| Location: P29 Roof, SW At Penetration Screw / Caulking / Mastic With Coating | | | (by CVES) by Rosa E. Pena on 02/26/23 |
| Analyst Description: White, Homogeneous, Fibrous, Caulking | | | |
| Asbestos Types: | | | |
| Other Material: Synthetic fibers 5%, Non-fibrous 95% | | | |
| 2302210029RK-37 | 923021478-37 | No | NAD |
| Location: P29 Roof, NW At Penetration Screw / Caulking / Mastic With Coating | | | (by CVES) by Rosa E. Pena on 02/26/23 |
| Analyst Description: White, Homogeneous, Fibrous, Caulking | | | |
| Asbestos Types: | | | |
| Other Material: Synthetic fibers 4%, Non-fibrous 96% | | | |
| 2302220029RK-38 | 923021478-38 | No | NAD |
| Location: P29 Exterior, North At Ramp / Coating On Wood Ramp / P29 Ramp | | | (by CVES) by Rosa E. Pena on 02/26/23 |
| Analyst Description: Grey, Homogeneous, Non-Fibrous, Coating | | | |
| Asbestos Types: | | | |
| Other Material: Non-fibrous 100% | | | |

PLM Bulk Asbestos Report

23-Z0046-0029; P28 & P29 & Ramps, Campus

| Client No. / HGA | Lab No. | Asbestos Present | Total % Asbestos |
|--|--------------|------------------|---|
| 2302220029RK-39 | 923021478-39 | No | NAD |
| Location: P29 Exterior, North At Ramp / Coating On Wood Ramp | | | (by CVES) by Rosa E. Pena on 02/26/23 |
| Analyst Description: Grey, Homogeneous, Non-Fibrous, Coating | | | |
| Asbestos Types: | | | |
| Other Material: Non-fibrous 100% | | | |
| 2302220029RK-40 | 923021478-40 | No | NAD |
| Location: P29 Exterior, North At Ramp / Coating On Wood Ramp | | | (by CVES) by Rosa E. Pena on 02/26/23 |
| Analyst Description: Grey, Homogeneous, Non-Fibrous, Coating | | | |
| Asbestos Types: | | | |
| Other Material: Non-fibrous 100% | | | |
| 2302220029RK-41 | 923021478-41 | No | NAD |
| Location: P28 Exterior, East At Ramp / Concrete Ramp / P28 Ramp | | | (by CVES) by Rosa E. Pena on 02/26/23 |
| Analyst Description: Grey, Homogeneous, Non-Fibrous, Cementitious, Concrete | | | |
| Asbestos Types: | | | |
| Other Material: Non-fibrous 100% | | | |
| 2302220029RK-42 | 923021478-42 | No | NAD |
| Location: P28 Exterior, NE At Ramp / Concrete Ramp | | | (by CVES) by Rosa E. Pena on 02/26/23 |
| Analyst Description: Grey, Homogeneous, Non-Fibrous, Cementitious, Concrete | | | |
| Asbestos Types: | | | |
| Other Material: Non-fibrous 100% | | | |
| 2302220029RK-43 | 923021478-43 | No | NAD |
| Location: P28 Exterior, NW At Ramp / Concrete Ramp | | | (by CVES) by Rosa E. Pena on 02/26/23 |
| Analyst Description: Grey, Homogeneous, Non-Fibrous, Cementitious, Concrete | | | |
| Asbestos Types: | | | |
| Other Material: Non-fibrous 100% | | | |
| 2302220029RK-44 | 923021478-44 | No | NAD |
| Location: Area 1, SE / Asphalt Paving / Area 1 (Area Surrounding P28 And P29) | | | (by CVES) by Rosa E. Pena on 02/26/23 |
| Analyst Description: Black, Homogeneous, Non-Fibrous, Cementitious, Asphalt | | | |
| Asbestos Types: | | | |
| Other Material: Non-fibrous 100% | | | |

PLM Bulk Asbestos Report

23-Z0046-0029; P28 & P29 & Ramps, Campus

| Client No. / HGA | Lab No. | Asbestos Present | Total % Asbestos |
|--|----------------|-------------------------|--|
| 2302220029RK-45 Location: Area 1, SW / Asphalt Paving Analyst Description: Black, Homogeneous, Non-Fibrous, Cementitious, Asphalt Asbestos Types: Other Material: Non-fibrous 100% | 923021478-45 | No | NAD (by CVES) by Rosa E. Pena on 02/26/23 |
| 2302220029RK-46 Location: Area 1, NW / Asphalt Paving Analyst Description: Black, Homogeneous, Non-Fibrous, Cementitious, Asphalt Asbestos Types: Other Material: Non-fibrous 100% | 923021478-46 | No | NAD (by CVES) by Rosa E. Pena on 02/26/23 |
| 2302220029RK-47 Location: Area 1, North Between P28 And P29 / Asphalt Paving Analyst Description: Black, Homogeneous, Non-Fibrous, Cementitious, Asphalt Asbestos Types: Other Material: Non-fibrous 100% | 923021478-47 | No | NAD (by CVES) by Rosa E. Pena on 02/26/23 |
| 2302220029RK-48 Location: Area 1, NE/ Asphalt Paving Analyst Description: Black, Homogeneous, Non-Fibrous, Cementitious, Asphalt Asbestos Types: Other Material: Non-fibrous 100% | 923021478-48 | No | NAD (by CVES) by Rosa E. Pena on 02/26/23 |
| 2302220029RK-49 Location: Area 1, SE / Concrete Footing / Area 1 (Area Surrounding P28 And P29) South At Fence Footings Analyst Description: Black/White, Heterogeneous, Non-Fibrous, Cementitious, Concrete Asbestos Types: Other Material: Non-fibrous 100% | 923021478-49 | No | NAD (by CVES) by Rosa E. Pena on 02/26/23 |
| 2302220029RK-50 Location: Area 1, South / Concrete Footing Analyst Description: White/Green, Heterogeneous, Non-Fibrous, Cementitious, Concrete Asbestos Types: Other Material: Non-fibrous 100% | 923021478-50 | No | NAD (by CVES) by Rosa E. Pena on 02/26/23 |

PLM Bulk Asbestos Report

23-Z0046-0029; P28 & P29 & Ramps, Campus

| Client No. / HGA | Lab No. | Asbestos Present | Total % Asbestos |
|---|--------------|------------------|--|
| 2302220029RK-51 Location: Area 1, SW / Concrete Footing Analyst Description: White/Black, Heterogeneous, Non-Fibrous, Cementitious, Concrete Asbestos Types: Other Material: Non-fibrous 100% | 923021478-51 | No | NAD (by CVES) by Rosa E. Pena on 02/26/23 |
| 2302220029RK-52 Location: Area 1, SW Of P2 On Walkway / Concrete Walkway / Area 1 (Area Surrounding P28 And P29) Walkway Between P26 And P2) Analyst Description: Grey, Homogeneous, Non-Fibrous, Cementitious, Concrete Asbestos Types: Other Material: Non-fibrous 100% | 923021478-52 | No | NAD (by CVES) by Rosa E. Pena on 02/26/23 |
| 2302220029RK-53 Location: Area 1, West Of P2 On Walkway / Concrete Walkway Analyst Description: Grey, Homogeneous, Non-Fibrous, Cementitious, Concrete Asbestos Types: Other Material: Non-fibrous 100% | 923021478-53 | No | NAD (by CVES) by Rosa E. Pena on 02/26/23 |
| 2302220029RK-54 Location: Area 1, East Of P26 On Walkway / Concrete Walkway Analyst Description: Grey, Homogeneous, Non-Fibrous, Cementitious, Concrete Asbestos Types: Other Material: Non-fibrous 100% | 923021478-54 | No | NAD (by CVES) by Rosa E. Pena on 02/26/23 |
| 2302220029RK-55 Location: Area 2, North At Curb / Concrete Walkway And Curb / Area 2 (Area NW Of Bldg MPR) Analyst Description: Grey, Homogeneous, Non-Fibrous, Cementitious, Concrete Asbestos Types: Other Material: Non-fibrous 100% | 923021478-55 | No | NAD (by CVES) by Rosa E. Pena on 02/26/23 |
| 2302220029RK-56 Location: Area 2, North Walkway / Concrete Walkway And Curb Analyst Description: Grey, Homogeneous, Non-Fibrous, Cementitious, Concrete Asbestos Types: Other Material: Non-fibrous 100% | 923021478-56 | No | NAD (by CVES) by Rosa E. Pena on 02/26/23 |

PLM Bulk Asbestos Report

23-Z0046-0029; P28 & P29 & Ramps, Campus

| Client No. / HGA | Lab No. | Asbestos Present | Total % Asbestos |
|--|--------------|------------------|---|
| 2302220029RK-57 | 923021478-57 | No | NAD |
| Location: Area 2, NE Walkway / Concrete Walkway And Curb | | | (by CVES) by Rosa E. Pena on 02/26/23 |
| Analyst Description: Grey, Homogeneous, Non-Fibrous, Cementitious, Concrete | | | |
| Asbestos Types: | | | |
| Other Material: Non-fibrous 100% | | | |
| 2302220029RK-58 | 923021478-58 | No | NAD |
| Location: Area 2, North / Asphalt Paving / Area 2 (Area NW Of Bldg (MPR) | | | (by CVES) by Rosa E. Pena on 02/26/23 |
| Analyst Description: Black, Homogeneous, Non-Fibrous, Cementitious, Asphalt | | | |
| Asbestos Types: | | | |
| Other Material: Non-fibrous 100% | | | |
| 2302220029RK-59 | 923021478-59 | No | NAD |
| Location: Area 2, SE / Asphalt Paving | | | (by CVES) by Rosa E. Pena on 02/26/23 |
| Analyst Description: Black, Homogeneous, Non-Fibrous, Cementitious, Asphalt | | | |
| Asbestos Types: | | | |
| Other Material: Non-fibrous 100% | | | |
| 2302220029RK-60 | 923021478-60 | No | NAD |
| Location: Area 2, South / Asphalt Paving | | | (by CVES) by Rosa E. Pena on 02/26/23 |
| Analyst Description: Black, Homogeneous, Non-Fibrous, Cementitious, Asphalt | | | |
| Asbestos Types: | | | |
| Other Material: Non-fibrous 100% | | | |
| 2302220029RK-61 | 923021478-61 | No | NAD |
| Location: Area 3, SW / Concrete Walkway / Area 3 (Area Between Bldg. G RR Bldg And Staff RR Bldg) | | | (by CVES) by Rosa E. Pena on 02/26/23 |
| Analyst Description: Grey, Homogeneous, Non-Fibrous, Cementitious, Concrete | | | |
| Asbestos Types: | | | |
| Other Material: Non-fibrous 100% | | | |
| 2302220029RK-62 | 923021478-62 | No | NAD |
| Location: Area 3, NW / Concrete Walkway | | | (by CVES) by Rosa E. Pena on 02/26/23 |
| Analyst Description: Grey, Homogeneous, Non-Fibrous, Cementitious, Concrete | | | |
| Asbestos Types: | | | |
| Other Material: Non-fibrous 100% | | | |

PLM Bulk Asbestos Report

23-Z0046-0029; P28 & P29 & Ramps, Campus

| Client No. / HGA | Lab No. | Asbestos Present | Total % Asbestos |
|--|--------------|------------------|--|
| 2302220029RK-63 Location: Area 3, North / Concrete Walkway Analyst Description: Grey, Homogeneous, Non-Fibrous, Cementitious, Concrete Asbestos Types: Other Material: Non-fibrous 100% | 923021478-63 | No | NAD (by CVES) by Rosa E. Pena on 02/26/23 |
| 2302220029RK-64 Location: Area 4, SE At Curb / Concrete Curb / Area 4 (SW Playground) At Perimeter Of Playground Analyst Description: Grey, Homogeneous, Non-Fibrous, Cementitious, Concrete Asbestos Types: Other Material: Non-fibrous 100% | 923021478-64 | No | NAD (by CVES) by Rosa E. Pena on 02/26/23 |
| 2302220029RK-65 Location: Area 4, NE At Curb / Concrete Curb Analyst Description: Grey, Homogeneous, Non-Fibrous, Cementitious, Concrete Asbestos Types: Other Material: Non-fibrous 100% | 923021478-65 | No | NAD (by CVES) by Rosa E. Pena on 02/26/23 |
| 2302220029RK-66 Location: Area 4, SW Perimeter Of Playground At Curb / Concrete Curb Analyst Description: Grey, Homogeneous, Non-Fibrous, Cementitious, Concrete Asbestos Types: Other Material: Non-fibrous 100% | 923021478-66 | No | NAD (by CVES) by Rosa E. Pena on 02/26/23 |
| 2302220029RK-67 Location: Area 4, NE At Paving / Asphalt Paving / Area 4 (SW Playground) Paving North Of Playground Analyst Description: Black, Homogeneous, Non-Fibrous, Cementitious, Asphalt Asbestos Types: Other Material: Non-fibrous 100% | 923021478-67 | No | NAD (by CVES) by Rosa E. Pena on 02/26/23 |
| 2302220029RK-68 Location: Area 4, North At Paving / Asphalt Paving Analyst Description: Black, Homogeneous, Non-Fibrous, Cementitious, Asphalt Asbestos Types: Other Material: Non-fibrous 100% | 923021478-68 | No | NAD (by CVES) by Rosa E. Pena on 02/26/23 |

PLM Bulk Asbestos Report

23-Z0046-0029; P28 & P29 & Ramps, Campus

| Client No. / HGA | Lab No. | Asbestos Present | Total % Asbestos |
|--|--------------|------------------|---|
| 2302220029RK-69 | 923021478-69 | No | NAD |
| Location: Area 4, NW At Paving / Asphalt Paving | | | (by CVES) by Rosa E. Pena on 02/26/23 |
| Analyst Description: Black, Homogeneous, Non-Fibrous, Cementitious, Asphalt | | | |
| Asbestos Types: | | | |
| Other Material: Non-fibrous 100% | | | |
| 2302220029RK-70 | 923021478-70 | No | NAD |
| Location: Area 5, North At Walkway To Main Entry Of Campus / Concrete Walkway And Curb / Area 5 (Playground North Of Bldg. H Rooms 19-20) | | | (by CVES) by Rosa E. Pena on 02/26/23 |
| Analyst Description: Grey, Homogeneous, Non-Fibrous, Cementitious, Concrete | | | |
| Asbestos Types: | | | |
| Other Material: Non-fibrous 100% | | | |
| 2302220029RK-71 | 923021478-71 | No | NAD |
| Location: Area 5, North At Walkway To Playground Entry / Concrete Walkway And Curb | | | (by CVES) by Rosa E. Pena on 02/26/23 |
| Analyst Description: Grey, Homogeneous, Non-Fibrous, Cementitious, Concrete | | | |
| Asbestos Types: | | | |
| Other Material: Non-fibrous 100% | | | |
| 2302220029RK-72 | 923021478-72 | No | NAD |
| Location: Area 5, Walkway West Of Playground / Concrete Walkway And Curb | | | (by CVES) by Rosa E. Pena on 02/26/23 |
| Analyst Description: Grey, Homogeneous, Non-Fibrous, Cementitious, Concrete | | | |
| Asbestos Types: | | | |
| Other Material: Non-fibrous 100% | | | |
| 2302220029RK-73 | 923021478-73 | No | NAD |
| Location: Area 5, Curb At SW Section Of Playground / Concrete Walkway And Curb | | | (by CVES) by Rosa E. Pena on 02/26/23 |
| Analyst Description: Grey, Homogeneous, Non-Fibrous, Cementitious, Concrete | | | |
| Asbestos Types: | | | |
| Other Material: Non-fibrous 100% | | | |
| 2302220029RK-74 | 923021478-74 | No | NAD |
| Location: Area 5, West Of Playground / Asphalt Paving / Area 5 (Playground North Of Bldg. H Rooms 19-20) | | | (by CVES) by Rosa E. Pena on 02/26/23 |
| Analyst Description: Black, Homogeneous, Non-Fibrous, Cementitious, Asphalt | | | |
| Asbestos Types: | | | |
| Other Material: Non-fibrous 100% | | | |

Client Name: Executive Environmental Services Corporation

PLM Bulk Asbestos Report

23-Z0046-0029; P28 & P29 & Ramps, Campus

| Client No. / HGA | Lab No. | Asbestos Present | Total % Asbestos |
|---|--------------|------------------|---|
| 2302220029RK-75 | 923021478-75 | No | NAD |
| Location: Area 5, West Of Playground / Asphalt Paving | | | (by CVES) by Rosa E. Pena on 02/26/23 |
| Analyst Description: Black, Homogeneous, Non-Fibrous, Cementitious, Asphalt | | | |
| Asbestos Types: | | | |
| Other Material: Non-fibrous 100% | | | |
| 2302220029RK-76 | 923021478-76 | No | NAD |
| Location: Area 5, SW Of Playground / Asphalt Paving | | | (by CVES) by Rosa E. Pena on 02/26/23 |
| Analyst Description: Black, Homogeneous, Non-Fibrous, Cementitious, Asphalt | | | |
| Asbestos Types: | | | |
| Other Material: Non-fibrous 100% | | | |

Reporting Notes:

Analyzed by: Rosa E. Pena
Date: 2/25/2023



Reviewed by: Patricia Weakley



*NAD = no asbestos detected; Detection Limit <1%; Reporting Limits: CVES = 1%, 400 Pt Ct = 0.25%, 1000 Pt Ct = 0.1%; NA = not analyzed; NA/PS = not analyzed / positive stop; NVA = No Visible Asbestos; PLM (polarized light microscopy) Bulk Asbestos Analysis by EPA 600/R-93/116, including requirements for EPA 600/M4-82-020 per 40 CFR 763 (NVLAP Lab #200346-0); Note: PLM is not consistently reliable in detecting asbestos in floor coverings and similar NOB materials. TEM is currently the only method that can be used to determine if this material can be considered or treated as non-asbestos-containing in New York State (also see EPA Advisory for floor tile, FR 59, 146, 38970, 8/1/94). NIST Accreditation requirements mandate that this report must not be reproduced except in full with the approval of the laboratory. This PLM report relates ONLY to the items tested.



Industrial Hygiene Laboratory Submittal Asbestos -- PLM

023021478

Originating Office

☒ 310 E. Foothill Blvd., Suite 200
Arcadia, CA 91006
Phone: 626.441.7050
Fax: 626.441.0016

Lab Submitted to:

☒ AmeriSci
☐ EMLab (Glendale)
☐ LA Testing

☐ Routine
(5 Working Days)

☐ RUSH (surcharges may apply)
Circle One 6 24 48 3 to 5 days
hours hours hours

Project #:
23-Z0046-0029

Sampled by:
Rhys Kuzmic

Site Zip Code:
91770

Sample Date:
02/21/2023

Page 1 of 12

The receiving Laboratory is required to complete the following:

1. All invoices are to be sent to: 310 E. Foothill Blvd., Suite 200, Arcadia, CA 91006 with a copy of the lab report.
2. Analyze all samples by PLM by EPA 600/R-93/116.
3. Stop analysis of homogeneous groups at first positive that is greater than or equal to 1.0%

Building Name: P28

4. All lab reports and invoices are to contain the Project Number from above.
5. Unsigned and reports marked draft are unacceptable.
6. Report to the attention of: Yesenia Galeana, Phone: (562) 889-1327

Optional Items to be completed by the laboratory (if check marked): ☒

Email Report to: ☒ Info@execenv.com

☒ Other: ygaleana@execenv.com;

☒ US Mail Report to: ☒ Originating office check marked above ☐ Other:

☐ Alternate billing address:

| Sample No.: | Sample Location - Include Room information where appropriate | Material Description | Homogeneous Location | No. | Quantity | Percent Damaged |
|-------------|--|--------------------------|--|-----|----------|-----------------|
| -01 | P28, SW | Blue sheet flooring and | P28, Restroom 1, Restroom 2 floor | 1 | 920 SF | 0 |
| -02 | Restroom 2, North | gine (on wood) | | ↓ | ↓ | ↓ |
| -03 | Restroom 1, NW | ↓ | | ↓ | ↓ | ↓ |
| -04 | P28, south wall | Vinyl baseboard adhesive | P28, Restroom 1, Restroom 2 walls and cabinets | 2 | 160 LK | 0 |
| -05 | Restroom 2, North wall | ↓ | | ↓ | ↓ | ↓ |
| -06 | P28, north wall of Restroom 1 at sink cabinet | ↓ | | ↓ | ↓ | ↓ |
| | | | | | | |
| | | | | | | |

Notes:

| | | | | | |
|----------------------------|--------------------------------|----------------------------|-----------------------------------|----------------------------|--|
| Released By, Date, & Time: | Rhys Kuzmic 02/24/2023 6:45 AM | Received By, Date, & Time: | Glenda Lujan Glenda 02-24-23 8:00 | Released By, Date, & Time: | |
|----------------------------|--------------------------------|----------------------------|-----------------------------------|----------------------------|--|



Industrial Hygiene Laboratory Submittal Asbestos -- PLM

Originating Office

☒ 310 E. Foothill Blvd., Suite 200
Arcadia, CA 91006
Phone: 626.441.7050
Fax: 626.441.0016

Lab Submitted to:

☒ AmeriSci
☐ EMLab (Glendale)
☐ LA Testing

☐ Routine
(5 Working Days)

☐ RUSH (surcharges may apply)
Circle One 6 24 48 3 to 5 days
hours hours hours

Project #:
23-Z0046-0029

Sampled by:
Rhys Kuzmic

Site Zip Code:
91770

Sample Date:
02/21/2023

Page 2 of 12

The receiving Laboratory is required to complete the following:

1. All invoices are to be sent to: 310 E. Foothill Blvd., Suite 200, Arcadia, CA 91006 with a copy of the lab report.
2. Analyze all samples by PLM by EPA 600/R-93/116.
3. Stop analysis of homogeneous groups at first positive that is greater than or equal to 1.0%

Building Name: P28

4. All lab reports and invoices are to contain the Project Number from above.
5. Unsigned and reports marked draft are unacceptable.
6. Report to the attention of: Yesenia Galeana, Phone: (562) 889-1327

Optional Items to be completed by the laboratory (if check marked): ☒

Email Report to: ☒ Info@execenv.com ☒ Other: ygaleana@execenv.com;

☒ US Mail Report to: ☒ Originating office check marked above ☐ Other:

☐ Alternate billing address:

| Sample No.: | Sample Location – Include Room information where appropriate | Material Description | Homogeneous Location | No. | Quantity | Percent Damaged |
|-------------|--|---------------------------|---|-----|----------|-----------------|
| -07 | Restroom 2, west wall | FRP adhesive (on drywall) | Restroom 1, Restroom 2 walls | 3 | 500 sf | 0 |
| -08 | Restroom 1, west wall | | | | | |
| -09 | Restroom 1, west wall | | | | | |
| -10 | P28, north wall above drop ceiling | Drywall no joint compound | P28 behind fiberboard walls Restroom 1 and Restroom 2 | 4 | 1,600 sf | 0 |
| -11 | P28, south wall above drop ceiling | behind fiberboard and FRP | behind FRP | | | |
| -12 | Restroom 2, east wall above drop ceiling | with fiberboard adhesive | | | | |
| | | | | | | |
| | | | | | | |

Notes:

| | | | | | |
|----------------------------|----------------------------|----------------------------|---------------------------------|----------------------------|--|
| Released By, Date, & Time: | Rhys Kuz 02/24/2023 6:45AM | Received By, Date, & Time: | Mark from Glendale 2/24/23 2:00 | Released By, Date, & Time: | |
|----------------------------|----------------------------|----------------------------|---------------------------------|----------------------------|--|



Industrial Hygiene Laboratory Submittal Asbestos -- PLM

Originating Office

☒ 310 E. Foothill Blvd., Suite 200
Arcadia, CA 91006
Phone: 626.441.7050
Fax: 626.441.0016

Lab Submitted to:

☒ AmeriSci
☐ EMLab (Glendale)
☐ LA Testing

☐ Routine
(5 Working Days)

☐ RUSH (surcharges may apply)
Circle One 6 24 48 3 to 5 days
hours hours hours

Project #:
23-Z0046-0029

Sampled by:
Rhys Kuzmic

Site Zip Code:
91770

Sample Date:
02/21/2023

Page 3 of 12

The receiving Laboratory is required to complete the following:

1. All invoices are to be sent to: 310 E. Foothill Blvd., Suite 200, Arcadia, CA 91006 with a copy of the lab report.
2. Analyze all samples by PLM by EPA 600/R-93/116.
3. Stop analysis of homogeneous groups at first positive that is greater than or equal to 1.0%

Building Name: P28

4. All lab reports and invoices are to contain the Project Number from above.
5. Unsigned and reports marked draft are unacceptable.
6. Report to the attention of: Yesenia Galeana, Phone: (562) 889-1327

Optional Items to be completed by the laboratory (if check marked): ☒

Email Report to: ☒ Info@execenv.com ☒ Other: ygaleana@execenv.com;

☒ US Mail Report to: ☒ Originating office check marked above ☐ Other:

☐ Alternate billing address:

| Sample No.: | Sample Location – Include Room information where appropriate | Material Description | Homogeneous Location | No. | Quantity | Percent Damaged |
|-------------|--|----------------------------|--|-----|----------|-----------------|
| -13 | P28, NW | 2x4 fissured ceiling panel | P28, Restroom 1, Restroom 2 ceilings | 5 | 920 SF | 0 |
| -14 | P28, SW | Suspended no glue | | ↓ | ↓ | ↓ |
| -15 | Restroom 2, West | ↓ | | ↓ | ↓ | ↓ |
| -16 | P28 roof, NE at penetration screw | Caulk/mastic with coating | P28 +0 roof on metal and caulking on gutters | 6 | 1,000 SF | 0 |
| -17 | P28 roof, east at roof jack | ↓ | | ↓ | ↓ | ↓ |
| -18 | P28 roof, north at penetration screw | ↓ | | ↓ | ↓ | ↓ |
| -19 | P28 roof, NE at gutter | ↓ | | ↓ | ↓ | ↓ |

Notes:

| | | | | | |
|----------------------------|-------------------------------|----------------------------|--|----------------------------|--|
| Released By, Date, & Time: | Rhys Kuzmic 02/24/2023 6:45AM | Received By, Date, & Time: | Glenda from Glenda Wilson 2/24/23 8:03 | Released By, Date, & Time: | |
|----------------------------|-------------------------------|----------------------------|--|----------------------------|--|



Industrial Hygiene Laboratory Submittal Asbestos -- PLM

Originating Office

☒ 310 E. Foothill Blvd., Suite 200
Arcadia, CA 91006
Phone: 626.441.7050
Fax: 626.441.0016

Lab Submitted to:

☒ AmeriSci
☐ EMLab (Glendale)
☐ LA Testing

☐ Routine
(5 Working Days)

☐ RUSH (surcharges may apply)
Circle One 6 24 48 3 to 5
hours hours hours days

Project #:
23-Z0046-0029

Sampled by:
Rhys Kuzmic

Site Zip Code:
91770

Sample Date:
02/21/2023

Page 4 of 12

The receiving Laboratory is required to complete the following:

1. All invoices are to be sent to: 310 E. Foothill Blvd., Suite 200, Arcadia, CA 91006 with a copy of the lab report.
2. Analyze all samples by PLM by EPA 600/R-93/116.
3. Stop analysis of homogeneous groups at first positive that is greater than or equal to 1.0%

Building Name: P28 and P29

4. All lab reports and invoices are to contain the Project Number from above.
5. Unsigned and reports marked draft are unacceptable.
6. Report to the attention of: Yesenia Galeana, Phone: (562) 889-1327

Optional Items to be completed by the laboratory (if check marked): ☒

Email Report to: ☒ Info@execenv.com ☒ Other: ygaleana@execenv.com;

☒ US Mail Report to: ☒ Originating office check marked above ☐ Other:

☐ Alternate billing address:

| Sample No.: | Sample Location – Include Room information where appropriate | Material Description | Homogeneous Location | No. | Quantity | Percent Damaged |
|-------------|--|-----------------------|---|-----|----------|-----------------|
| -20 | P28: Restroom 1 at sink | Caulkings | P28: Restrooms 1 and 2 at sinks and toilets | 7 | 1SF | 0 |
| -21 | P28: Restroom 1 at toilet | ↓ | | ↓ | ↓ | ↓ |
| -22 | P28: Restroom 2 at sink | | | ↓ | ↓ | ↓ |
| -23 | P29, NE | Carpet glue (on wood) | P29 floor | 8 | 920SF | 0 |
| -24 | P29, SE | ↓ | | ↓ | ↓ | ↓ |
| -25 | P29, NW | | | ↓ | ↓ | ↓ |
| | | | | | | |
| | | | | | | |

Notes:

| | | |
|---|---|----------------------------|
| Released By, Date, & Time: Rhys Kuz 02/24/2023 6:45AM | Received By, Date, & Time: YGaleana from Glenda Lizon 2/24/23 2:50 PM | Released By, Date, & Time: |
|---|---|----------------------------|



Industrial Hygiene Laboratory Submittal Asbestos -- PLM

Originating Office

☒ 310 E. Foothill Blvd., Suite 200
Arcadia, CA 91006
Phone: 626.441.7050
Fax: 626.441.0016

Lab Submitted to:

☒ AmeriSci
☐ EMLab (Glendale)
☐ LA Testing

☐ Routine
(5 Working Days)

☐ RUSH (surcharges may apply)
Circle 6 24 48 3 to 5
One hours hours days

Project #:
23-Z0046-0029

Sampled by:
Rhys Kuzmic

Site Zip Code:
91770

Sample Date:
02/21/2023

Page 5 of 12

The receiving Laboratory is required to complete the following:

1. All invoices are to be sent to: 310 E. Foothill Blvd., Suite 200, Arcadia, CA 91006 with a copy of the lab report.
2. Analyze all samples by PLM by EPA 600/R-93/116.
3. Stop analysis of homogeneous groups at first positive that is greater than or equal to 1.0%

Building Name: P29

4. All lab reports and invoices are to contain the Project Number from above.
5. Unsigned and reports marked draft are unacceptable.
6. Report to the attention of: Yesenia Galeana, Phone: (562) 889-1327

Optional Items to be completed by the laboratory (if check marked): ☒

Email Report to: ☒ Info@execenv.com ☒ Other: ygaleana@execenv.com;

☒ US Mail Report to: ☒ Originating office check marked above ☐ Other:

☐ Alternate billing address:

| Sample No.: | Sample Location – Include Room information where appropriate | Material Description | Homogeneous Location | No. | Quantity | Percent Damaged |
|-------------|--|-----------------------------------|-----------------------------|-----|----------|-----------------|
| -26 | P29, east wall | Vinyl baseboard adhesive | P29 walls | 9 | 120 LF | 0 |
| -27 | P29, north wall | | | | | |
| -28 | P29, south wall | ↓ | | ↓ | ↓ | ↓ |
| -29 | P29, west wall above drop ceiling | Drywall no joint compound | P29 walls behind fiberboard | 10 | 1,200 SF | 0 |
| -30 | P29, east wall above drop ceiling | behind fiberboard with fiberboard | | | | |
| -31 | P29, south wall above drop ceiling | adhesive | | ↓ | ↓ | ↓ |
| | | | | | | |
| | | | | | | |

Notes:

| | | | | | |
|----------------------------|----------------------------|----------------------------|---------------------------|----------------------------|--|
| Released By, Date, & Time: | Rhys Kuz 02/24/2023 6:45AM | Received By, Date, & Time: | Glenda Lopez 2-24-23 8:00 | Released By, Date, & Time: | |
|----------------------------|----------------------------|----------------------------|---------------------------|----------------------------|--|



Industrial Hygiene Laboratory Submittal Asbestos -- PLM

Originating Office

☒ 310 E. Foothill Blvd., Suite 200
Arcadia, CA 91006
Phone: 626.441.7050
Fax: 626.441.0016

Lab Submitted to:

☒ AmeriSci
☐ EMLab (Glendale)
☐ LA Testing

☐ Routine
(5 Working Days)

☐ RUSH (surcharges may apply)
Circle One 6 24 48 3 to 5
One hours hours hours days

Project #:
23-Z0046-0029

Sampled by:
Rhys Kuzmic

Site Zip Code:
91770

Sample Date:
02/21/2023

Page 6 of 12

The receiving Laboratory is required to complete the following:

1. All invoices are to be sent to: 310 E. Foothill Blvd., Suite 200, Arcadia, CA 91006 with a copy of the lab report.
2. Analyze all samples by PLM by EPA 600/R-93/116.
3. Stop analysis of homogeneous groups at first positive that is greater than or equal to 1.0%

Building Name: P29

4. All lab reports and invoices are to contain the Project Number from above.
5. Unsigned and reports marked draft are unacceptable.
6. Report to the attention of: Yesenia Galeana, Phone: (562) 889-1327

Optional Items to be completed by the laboratory (if check marked): ☒

Email Report to: ☒ Info@execenv.com ☒ Other: ygaleana@execenv.com;

☒ US Mail Report to: ☒ Originating office check marked above ☐ Other:

☐ Alternate billing address:

| Sample No.: | Sample Location – Include Room information where appropriate | Material Description | Homogeneous Location | No. | Quantity | Percent Damaged |
|-------------|--|------------------------------|--------------------------------|-----|----------|-----------------|
| -32 | P29, NW | 2x4 fissured ceiling panel | P29 ceiling | 11 | 920 SF | 0 |
| -33 | P29, NE | suspended - no glue | | | | |
| -34 | P29, south | ↓ | | ↓ | ↓ | ↓ |
| -35 | P29 roof, SE at gutter | Caulking/mastic with coating | P29 + 0 metal roof and gutters | 12 | 1,000 SF | 0 |
| -36 | P29 roof, SW at penetration screw | ↓ | | ↓ | ↓ | ↓ |
| -37 | P29 roof, NW at penetration screw | ↓ | | ↓ | ↓ | ↓ |
| | | | | | | |
| | | | | | | |

Notes:

| | | | | | |
|----------------------------|-------------------------------|----------------------------|---------------------------|----------------------------|--|
| Released By, Date, & Time: | Rhys Kuzmic 02/24/2023 6:45AM | Received By, Date, & Time: | Glenda Luzon 2-24-23 8:00 | Released By, Date, & Time: | |
|----------------------------|-------------------------------|----------------------------|---------------------------|----------------------------|--|



Industrial Hygiene Laboratory Submittal Asbestos -- PLM

Originating Office

☒ 310 E. Foothill Blvd., Suite 200
Arcadia, CA 91006
Phone: 626.441.7050
Fax: 626.441.0016

Lab Submitted to:

☒ AmeriSci
☐ EMLab (Glendale)
☐ LA Testing

☐ Routine
(5 Working Days)

☐ RUSH (surcharges may apply)
Circle One 6 24 48 3 to 5 days
hours hours hours

Project #:
23-Z0046-0029

Sampled by:
Rhys Kuzmic

Site Zip Code:
91770

Sample Date:
02/24/2023
22 25

Page 7 of 22

The receiving Laboratory is required to complete the following:

1. All invoices are to be sent to: 310 E. Foothill Blvd., Suite 200, Arcadia, CA 91006 with a copy of the lab report.
2. Analyze all samples by PLM by EPA 600/R-93/116.
3. Stop analysis of homogeneous groups at first positive that is greater than or equal to 1.0%

Building Name: P28 + P29 ramps

4. All lab reports and invoices are to contain the Project Number from above.
5. Unsigned and reports marked draft are unacceptable.
6. Report to the attention of: Yesenia Galeana, Phone: (562) 889-1327

Optional Items to be completed by the laboratory (if check marked): ☒

Email Report to: ☒ Info@execenv.com ☒ Other: ygaleana@execenv.com;

☒ US Mail Report to: ☒ Originating office check marked above ☐ Other:

☐ Alternate billing address:

| Sample No.: | Sample Location – Include Room information where appropriate | Material Description | Homogeneous Location | No. | Quantity | Percent Damaged |
|-------------|--|-----------------------|----------------------|-----|----------|-----------------|
| -38 | P29 exterior, north st ramp | Coatings on wood ramp | P29 ramp | 13 | 90 SF | <1 |
| -39 | P29 exterior, north st ramp | | | | | |
| -40 | P29 exterior, north st ramp | ↓ | | ↓ | ↓ | ↓ |
| -41 | P28 exterior, east st ramp | Concrete ramp | P28 ramp | 14 | 300 SF | 0 |
| -42 | P28 exterior, NR st ramp | | | | | |
| -43 | P28 exterior, NW st ramp | ↓ | | ↓ | ↓ | ↓ |
| | | | | | | |
| | | | | | | |

Notes:

| | | |
|---|--|----------------------------|
| Released By, Date, & Time: Rhys Kuz 02/24/2023 6:45AM | Received By, Date, & Time: Glenda from Glenda Lizon 2-24-23 8:00 | Released By, Date, & Time: |
|---|--|----------------------------|



Industrial Hygiene Laboratory Submittal Asbestos -- PLM

Originating Office

☒ 310 E. Foothill Blvd., Suite 200
Arcadia, CA 91006
Phone: 626.441.7050
Fax: 626.441.0016

Lab Submitted to:

☒ AmeriSci
☐ EMLab (Glendale)
☐ LA Testing

☐ Routine
(5 Working Days)

☐ RUSH (surcharges may apply)
Circle One 6 24 48 3 to 5 days
hours hours hours

Project #:
23-Z0046-0029

Sampled by:
Rhys Kuzmic

Site Zip Code:
91770

Sample Date:
02/21/2023

Page 8 of 12

The receiving Laboratory is required to complete the following:

1. All invoices are to be sent to: 310 E. Foothill Blvd., Suite 200, Arcadia, CA 91006 with a copy of the lab report.
2. Analyze all samples by PLM by EPA 600/R-93/116.
3. Stop analysis of homogeneous groups at first positive that is greater than or equal to 1.0%

Building Name: Campus

4. All lab reports and invoices are to contain the Project Number from above.
5. Unsigned and reports marked draft are unacceptable.
6. Report to the attention of: Yesenia Galeana, Phone: (562) 889-1327

Optional Items to be completed by the laboratory (if check marked): ☒

Email Report to: ☒ Info@execenv.com ☒ Other: ygaleana@execenv.com;

☒ US Mail Report to: ☒ Originating office check marked above ☐ Other:

☐ Alternate billing address:

| Sample No.: | Sample Location – Include Room information where appropriate | Material Description | Homogeneous Location | No. | Quantity | Percent Damaged |
|-------------|--|----------------------|---|-----|----------|-----------------|
| -44 | Area 1, SE | Asphalt Paving | Area 2 (Area Surrounding P28 and P29) | 15 | 3,500 SF | 0 |
| -45 | Area 1, SW | ↓ | | ↓ | ↓ | ↓ |
| -46 | Area 1, NW | | | ↓ | ↓ | ↓ |
| -47 | Area 1, north between P28 and P29 | | | ↓ | ↓ | ↓ |
| -48 | Area 1, NE | | | ↓ | ↓ | ↓ |
| -49 | Area 1, SE | Concrete Footings | Area 2 (Area Surrounding P28 and P29) south of fence footings | 16 | 12 SF | 0 |
| -50 | Area 1, south | ↓ | | ↓ | ↓ | ↓ |
| -51 | Area 1, SW | | | ↓ | ↓ | ↓ |

Notes:

Released By, Date, & Time:

Rhys Kuz 02/21/2023 6:45AM

Received By, Date, & Time:

Glenda Aron Glenda Luzon 2-21-23 8:00

Released By, Date, & Time:



Industrial Hygiene Laboratory Submittal Asbestos -- PLM

Originating Office

☒ 310 E. Foothill Blvd., Suite 200
Arcadia, CA 91006
Phone: 626.441.7050
Fax: 626.441.0016

Lab Submitted to:

☒ AmeriSci
☐ EMLab (Glendale)
☐ LA Testing

☐ Routine
(5 Working Days)

☐ RUSH (surcharges may apply)
Circle One 6 24 48 3 to 5 days

Project #:
23-Z0046-0029

Sampled by:
Rhys Kuzmic

Site Zip Code:
91770

Sample Date:
02/21/2023

Page 9 of 12

The receiving Laboratory is required to complete the following:

1. All invoices are to be sent to: 310 E. Foothill Blvd., Suite 200, Arcadia, CA 91006 with a copy of the lab report.
2. Analyze all samples by PLM by EPA 600/R-93/116.
3. Stop analysis of homogeneous groups at first positive that is greater than or equal to 1.0%

Building Name: Campus

4. All lab reports and invoices are to contain the Project Number from above.
5. Unsigned and reports marked draft are unacceptable.
6. Report to the attention of: Yesenia Galeana, Phone: (562) 889-1327

Optional Items to be completed by the laboratory (if check marked): ☒ Email Report to: ☒ Info@execenv.com ☒ Other: ygaleana@execenv.com;

☒ US Mail Report to: ☒ Originating office check marked above ☐ Other: ☐ Alternate billing address:

| Sample No.: | Sample Location – Include Room information where appropriate | Material Description | Homogeneous Location | No. | Quantity | Percent Damaged |
|-------------|--|---------------------------|---|-----|----------|-----------------|
| -52 | Area 1, SW of P27 on Walkway | Concrete Walkway | Area 1 (Area surrounding P28 and P29) walkway between P26 and P27 | 17 | 150 SF | 0 |
| -53 | Area 1, west of P27 on Walkway | ↓ | | ↓ | ↓ | ↓ |
| -54 | Area 1, east of P26 on Walkway | ↓ | | ↓ | ↓ | ↓ |
| -55 | Area 2, north of curb | Concrete walkway and curb | Area 2 (Area NW of Bldg C MPR) | 18 | 100 SF | 0 |
| -56 | Area 2, north walkway | ↓ | | ↓ | ↓ | ↓ |
| -57 | Area 2, NE Walkway | ↓ | | ↓ | ↓ | ↓ |
| | | | | | | |
| | | | | | | |

Notes:

| | | |
|---|--|----------------------------|
| Released By, Date, & Time: Rhys Kuz 02/21/2023 6:45AM | Received By, Date, & Time: Glenda Wilson 02/24/2023 8:00 | Released By, Date, & Time: |
|---|--|----------------------------|



Industrial Hygiene Laboratory Submittal Asbestos -- PLM

Originating Office

☒ 310 E. Foothill Blvd., Suite 200
Arcadia, CA 91006
Phone: 626.441.7050
Fax: 626.441.0016

Lab Submitted to:

☒ AmeriSci
☐ EMLab (Glendale)
☐ LA Testing

☐ Routine
(5 Working Days)

☐ RUSH (surcharges may apply)
Circle 6 24 48 3 to 5
One hours hours days

Project #:
23-Z0046-0029

Sampled by:
Rhys Kuzmic

Site Zip Code:
91770

Sample Date:
02/21/2023
2 (2)

Page 1 of 12

The receiving Laboratory is required to complete the following:

1. All invoices are to be sent to: 310 E. Foothill Blvd., Suite 200, Arcadia, CA 91006 with a copy of the lab report.
2. Analyze all samples by PLM by EPA 600/R-93/116.
3. Stop analysis of homogeneous groups at first positive that is greater than or equal to 1.0%

Building Name: Camp

4. All lab reports and invoices are to contain the Project Number from above.
5. Unsigned and reports marked draft are unacceptable.
6. Report to the attention of: Yessenia Galeana, Phone: (562) 889-1327

Optional Items to be completed by the laboratory (if check marked): ☒

Email Report to: ☒ Info@execenv.com ☒ Other: ygaleana@execenv.com;

☒ US Mail Report to: ☒ Originating office check marked above ☐ Other:

☐ Alternate billing address:

| Sample No.: | Sample Location – Include Room information where appropriate | Material Description | Homogeneous Location | No. | Quantity | Percent Damaged |
|-------------|--|----------------------|--|-----|----------|-----------------|
| -58 | Area 2, north | Asphalt paving | Area 2 (Area NW of Bldg C MPR) | 19 | 250 SF | <1 |
| -59 | Area 2, SE | ↓ | | ↓ | ↓ | ↓ |
| -60 | Area 2, south | ↓ | | ↓ | ↓ | ↓ |
| -61 | Area 3, SW | Concrete Walkway | Area 3 (Area between Bldg G RR Bldg and Staff RR Bldg) | 20 | 200 SF | 0 |
| -62 | Area 3, NW | ↓ | | ↓ | ↓ | ↓ |
| -63 | Area 3, north | ↓ | | ↓ | ↓ | ↓ |
| | | | | | | |
| | | | | | | |

Notes:

| | | | | | |
|----------------------------|---------------------------|----------------------------|-----------------------------|----------------------------|--|
| Released By, Date, & Time: | Rhys Kw 02/24/2023 6:45AM | Received By, Date, & Time: | Glenda Urian 2/24/2023 8:00 | Released By, Date, & Time: | |
|----------------------------|---------------------------|----------------------------|-----------------------------|----------------------------|--|



Industrial Hygiene Laboratory Submittal Asbestos -- PLM

Originating Office

☒ 310 E. Foothill Blvd., Suite 200
Arcadia, CA 91006
Phone: 626.441.7050
Fax: 626.441.0016

Lab Submitted to:

☒ AmeriSci
☐ EMLab (Glendale)
☐ LA Testing

☐ Routine
(5 Working Days)

☐ RUSH (surcharges may apply)
Circle 6 24 48 3 to 5
One hours hours hours days

Project #:
23-Z0046-0029

Sampled by:
Rhys Kuzmic

Site Zip Code:
91770

Sample Date:
02/21/2023

Page 11 of 12

The receiving Laboratory is required to complete the following:

1. All invoices are to be sent to: 310 E. Foothill Blvd., Suite 200, Arcadia, CA 91006 with a copy of the lab report.
2. Analyze all samples by PLM by EPA 600/R-93/116.
3. Stop analysis of homogeneous groups at first positive that is greater than or equal to 1.0%

Building Name: Campus

4. All lab reports and invoices are to contain the Project Number from above.
5. Unsigned and reports marked draft are unacceptable.
6. Report to the attention of: Yesenia Galeana, Phone: (562) 889-1327

Optional Items to be completed by the laboratory (if check marked): ☒

Email Report to: ☒ Info@execenv.com ☒ Other: ygaleana@execenv.com;

☒ US Mail Report to: ☒ Originating office check marked above ☐ Other:

☐ Alternate billing address:

| Sample No.: | Sample Location - Include Room information where appropriate | Material Description | Homogeneous Location | No. | Quantity | Percent Damaged |
|-------------|--|----------------------|---|-----|----------|-----------------|
| -64 | Area 4, SE st curb | Concrete curb | Area 4 (SW Playground) at perimeter of playground | 21 | 320 SF | <1 |
| -65 | Area 4, NE st curb | | | | | |
| -66 | Area 4, SW perimeter of playground st curb | | | | | |
| -67 | Area 4, NE st paving | Asphalt paving | Area 4 (SW Playground) paving north of playground | 22 | 500 SF | 0 |
| -68 | Area 4, north st paving | | | | | |
| -69 | Area 4, NW st paving | | | | | |
| | | | | | | |
| | | | | | | |

Notes:

| | | |
|---|--|----------------------------|
| Released By, Date, & Time: RmKw 02/24/2023 6:45AM | Received By, Date, & Time: Glenda Lizon Glenda Lizon 2.24.23 2:08:00 | Released By, Date, & Time: |
|---|--|----------------------------|



Industrial Hygiene Laboratory Submittal Asbestos -- PLM

Originating Office

☒ 310 E. Foothill Blvd., Suite 200
Arcadia, CA 91006
Phone: 626.441.7050
Fax: 626.441.0016

Lab Submitted to:

☒ AmeriSci
☐ EMLab (Glendale)
☐ LA Testing

☐ Routine
(5 Working Days)

☐ RUSH (surcharges may apply)
Circle 6 24 48 3 to 5 days
One hours hours hours

Project #:
23-Z0046-0029

Sampled by:
Rhys Kuzmic

Site Zip Code:
91770

Sample Date:
02/21/2023

Page 12 of 42

The receiving Laboratory is required to complete the following:

1. All invoices are to be sent to: 310 E. Foothill Blvd., Suite 200, Arcadia, CA 91006 with a copy of the lab report.
2. Analyze all samples by PLM by EPA 600/R-93/116.
3. Stop analysis of homogeneous groups at first positive that is greater than or equal to 1.0%

Building Name: Campus

4. All lab reports and invoices are to contain the Project Number from above.
5. Unsigned and reports marked draft are unacceptable.
6. Report to the attention of: Yesenia Galeana, Phone: (562) 889-1327

Optional Items to be completed by the laboratory (if check marked): ☒

Email Report to: ☒ Info@execenv.com

☒ Other: ygaleana@execenv.com;

☒ US Mail Report to: ☒ Originating office check marked above ☐ Other:

☐ Alternate billing address:

| Sample No.: | Sample Location - Include Room information where appropriate | Material Description | Homogeneous Location | No. | Quantity | Percent Damaged |
|-------------|--|---------------------------|---|-----|----------|-----------------|
| -70 | Area 5, north st walkway to main entry of campus | Concrete Walkway and curb | Area 5 (Playground north of Bldg 11 Rm 19-20) | 23 | 980 SF | 0 |
| -71 | Area 5, north st walkway to playground entry | ↓ | | ↓ | ↓ | ↓ |
| -72 | Area 5, walkway west of playground | | | ↓ | ↓ | ↓ |
| -73 | Area 5, curb st SW section of playground | | | ↓ | ↓ | ↓ |
| -74 | Area 5, west of playground | Asphalt Paving | Area 5 (Playground north of Bldg 11 Rm 19-20) | 24 | 500 SF | 0 |
| -75 | Area 5, west of playground | ↓ | | ↓ | ↓ | ↓ |
| -76 | Area 5, SW of playground | | | ↓ | ↓ | ↓ |

Notes:

Released By, Date, & Time:

Rhys Kuzmic 02/24/2023 6:45AM

Received By, Date, & Time:

Glenda Wilson 02/24/2023 8:00

Released By, Date, & Time:

APPENDIX B – SAMPLE LOCATIONS DRAWINGS

Portable 28

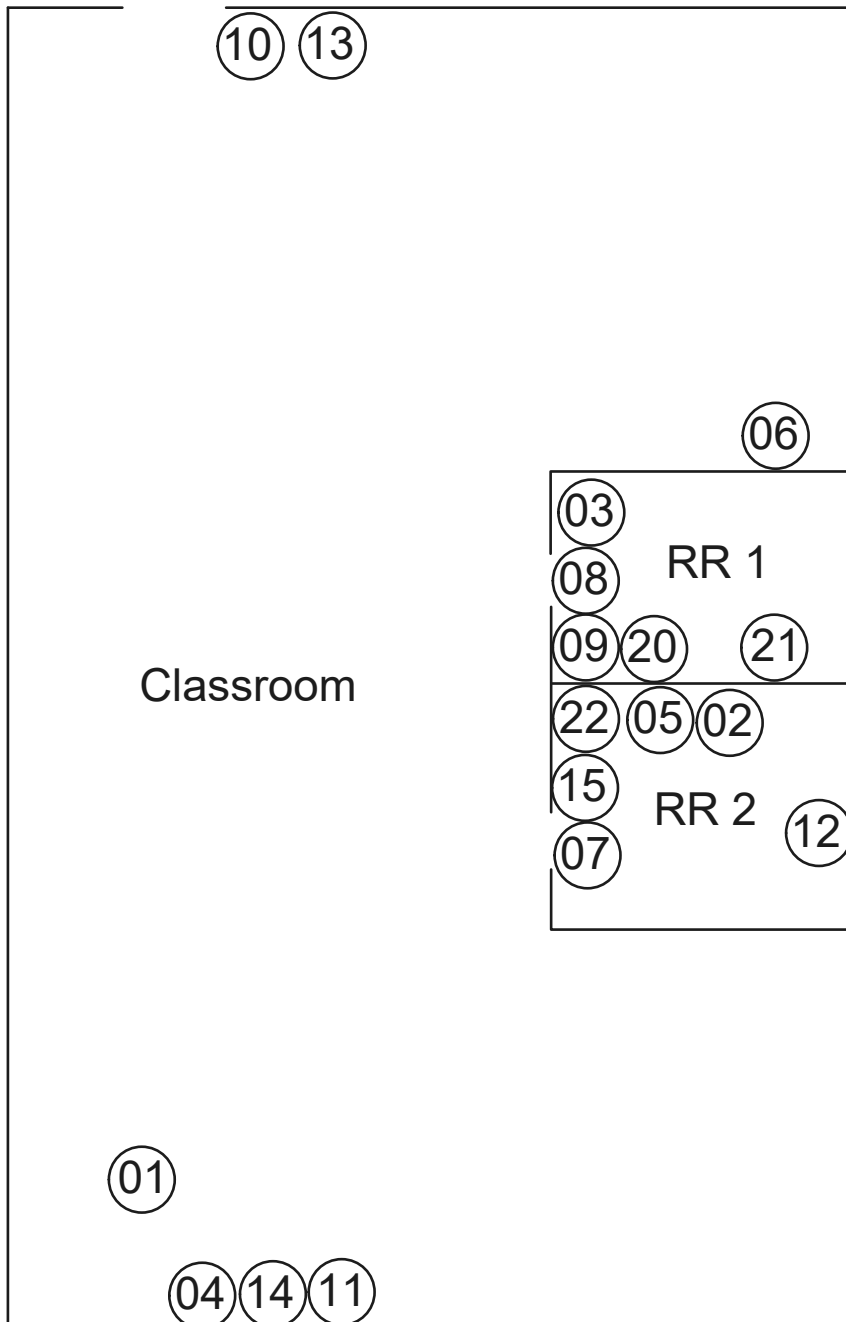

○ - PLM Sample



Client: Rosemead School District

Project#: 23-Z0046-0029

Info: PLM Sample Locations



EXECUTIVE ENVIRONMENTAL
HEALTH & SAFETY SIMPLIFIED

Site: Encinita Elementary School
Address: 4515 Encinita Avenue
Rosemead, California 91770

Drawing Not to Scale - © 2012

Portable 28

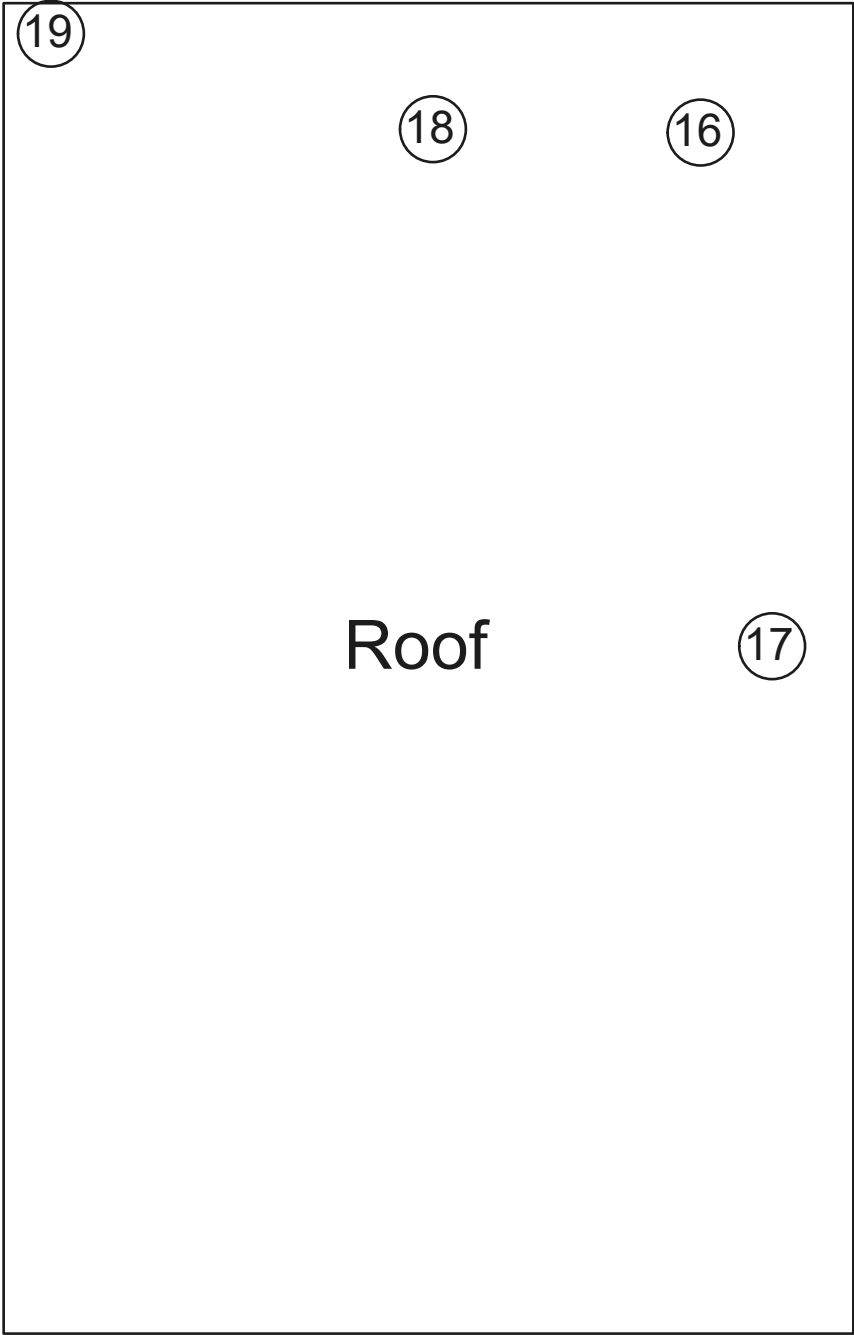

○ - PLM Sample



Portable 29

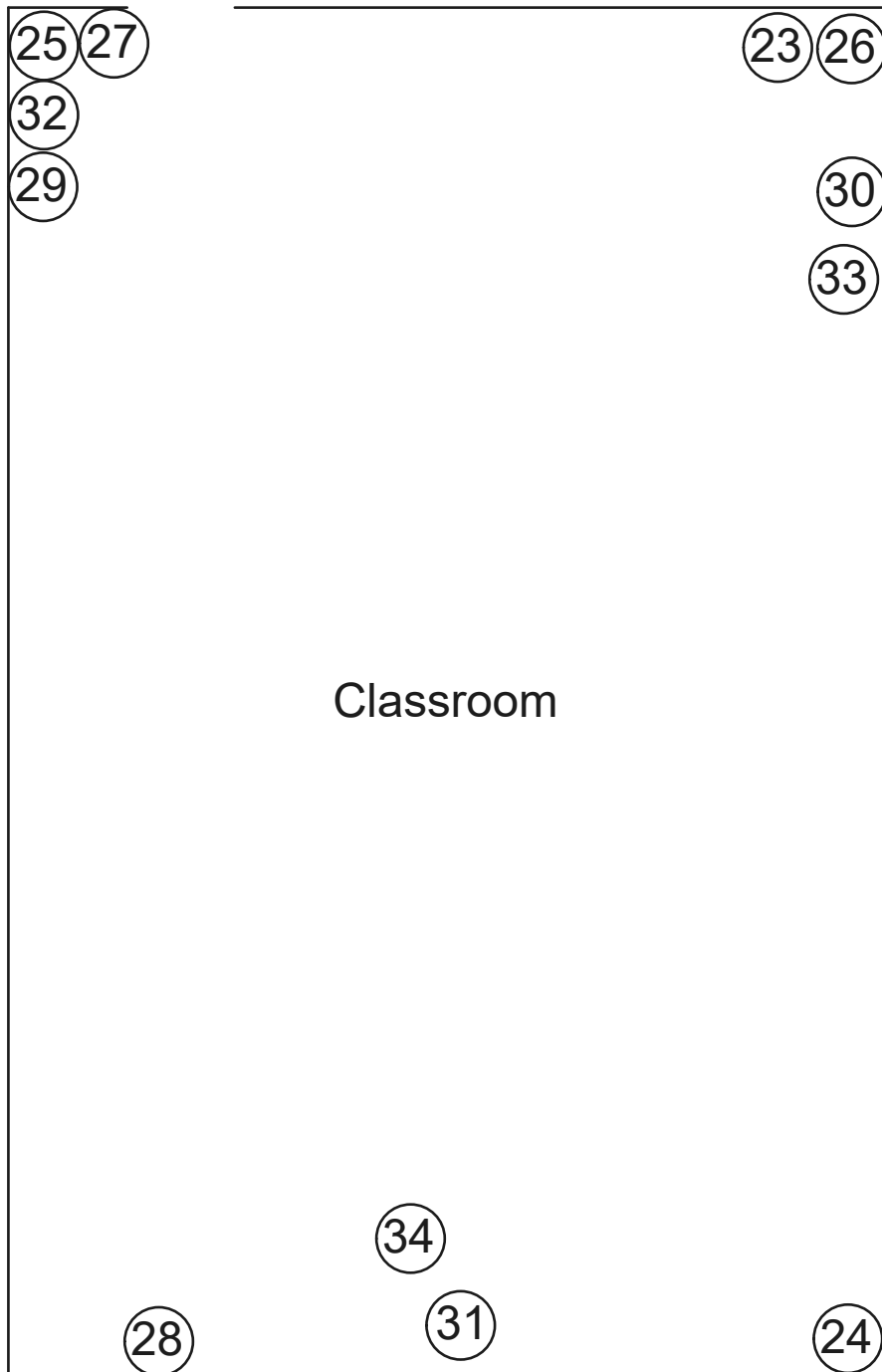

○ - PLM Sample



Client: Rosemead School District

Project#: 23-Z0046-0029

Info: PLM Sample Locations



EXECUTIVE ENVIRONMENTAL
HEALTH & SAFETY SIMPLIFIED

Site: Encinita Elementary School
Address: 4515 Encinita Avenue
Rosemead, California 91770

Drawing Not to Scale - © 2012

Portable 29

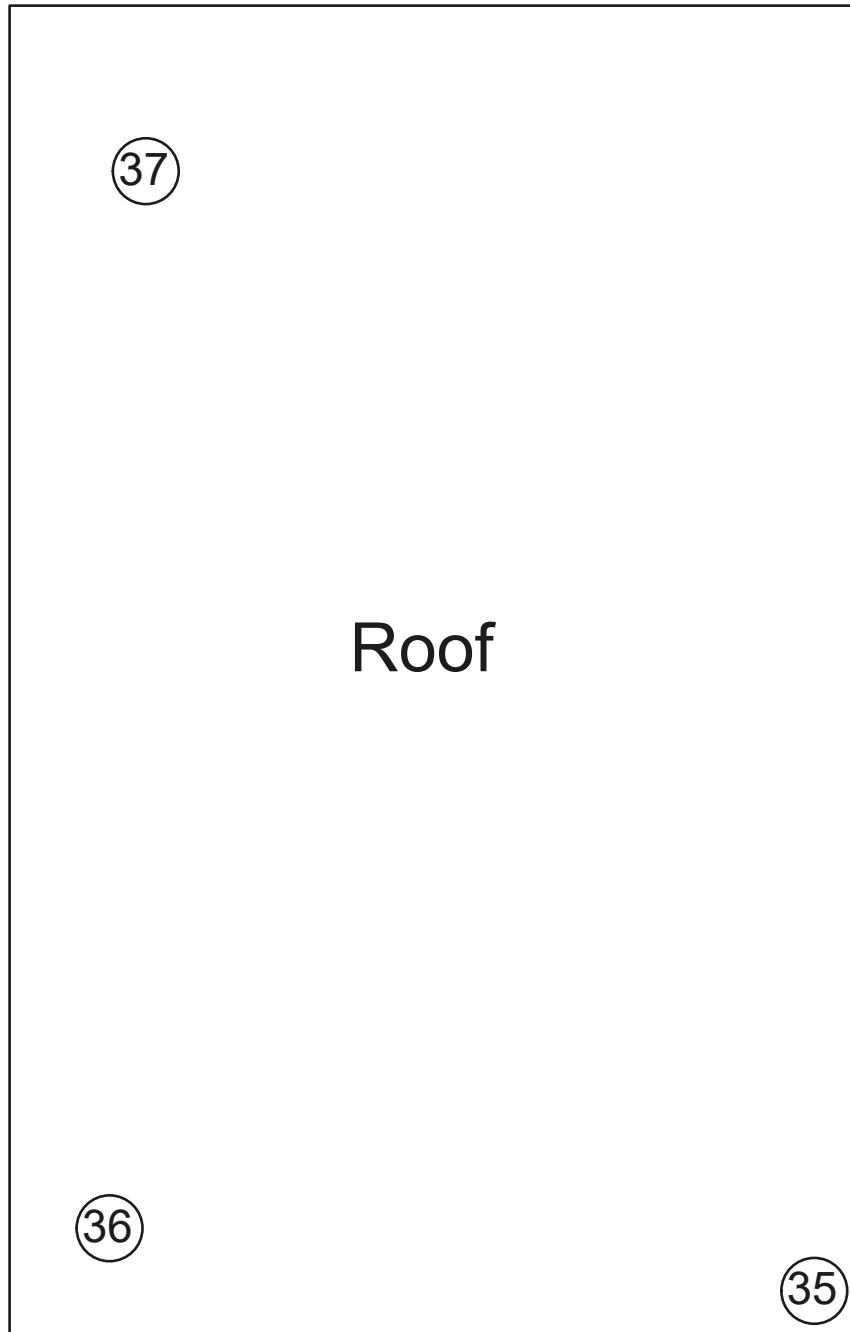

○ - PLM Sample



Client: Rosemead School District

Project#: 23-Z0046-0029

Info: PLM Sample Locations



EXECUTIVE ENVIRONMENTAL
HEALTH & SAFETY SIMPLIFIED

Site: Encinita Elementary School
Address: 4515 Encinita Avenue
Rosemead, California 91770

Drawing Not to Scale - © 2012

Encinita ES

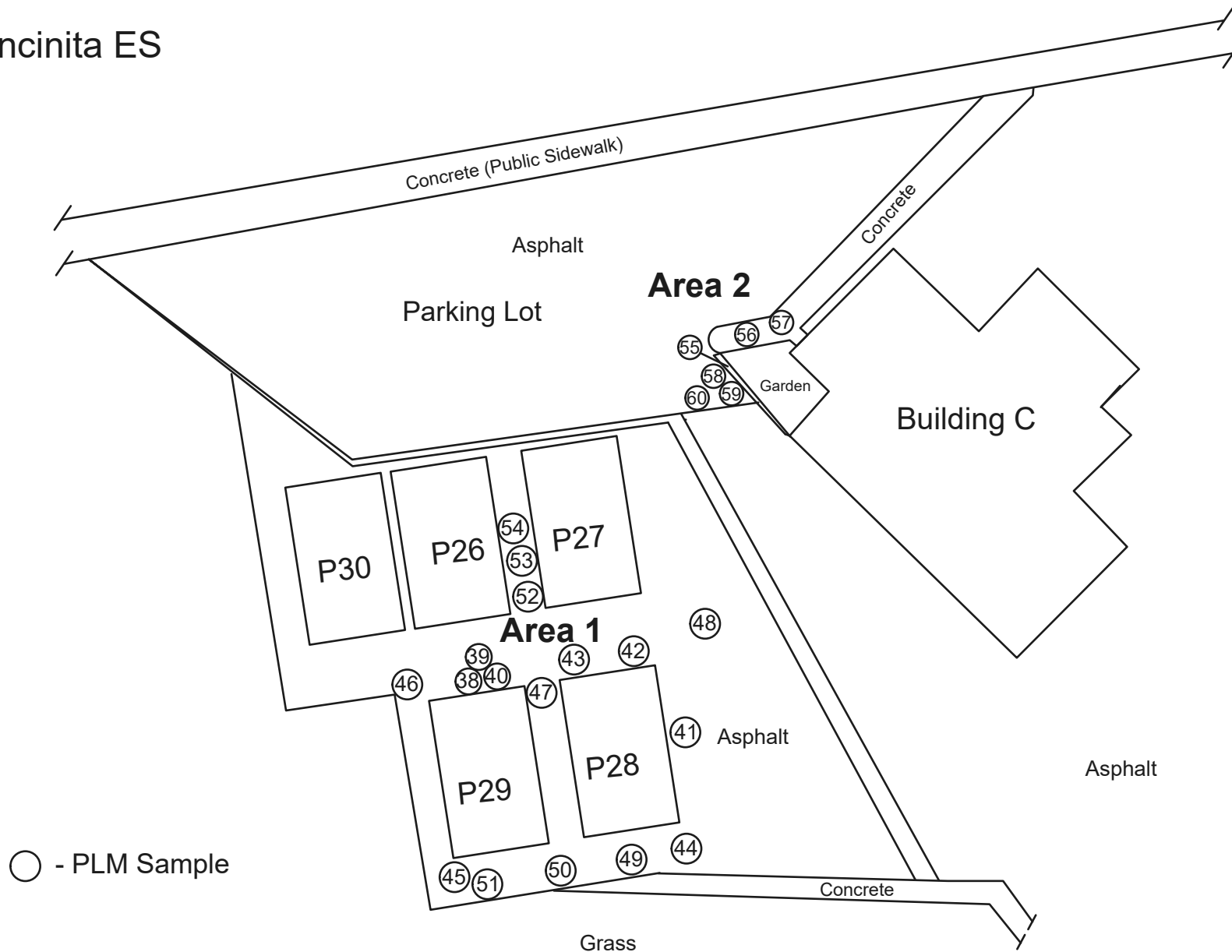

Client: Rosemead School District

Project #: 23-Z0046-0029

Info: PLM Sample Locations (Page 1 of 2)



EXECUTIVE ENVIRONMENTAL
HEALTH & SAFETY SIMPLIFIED

Site: Encinita Elementary School
Address: 4515 Encinita Avenue
Rosemead, California 91770

Drawing Not to Scale - © 2012

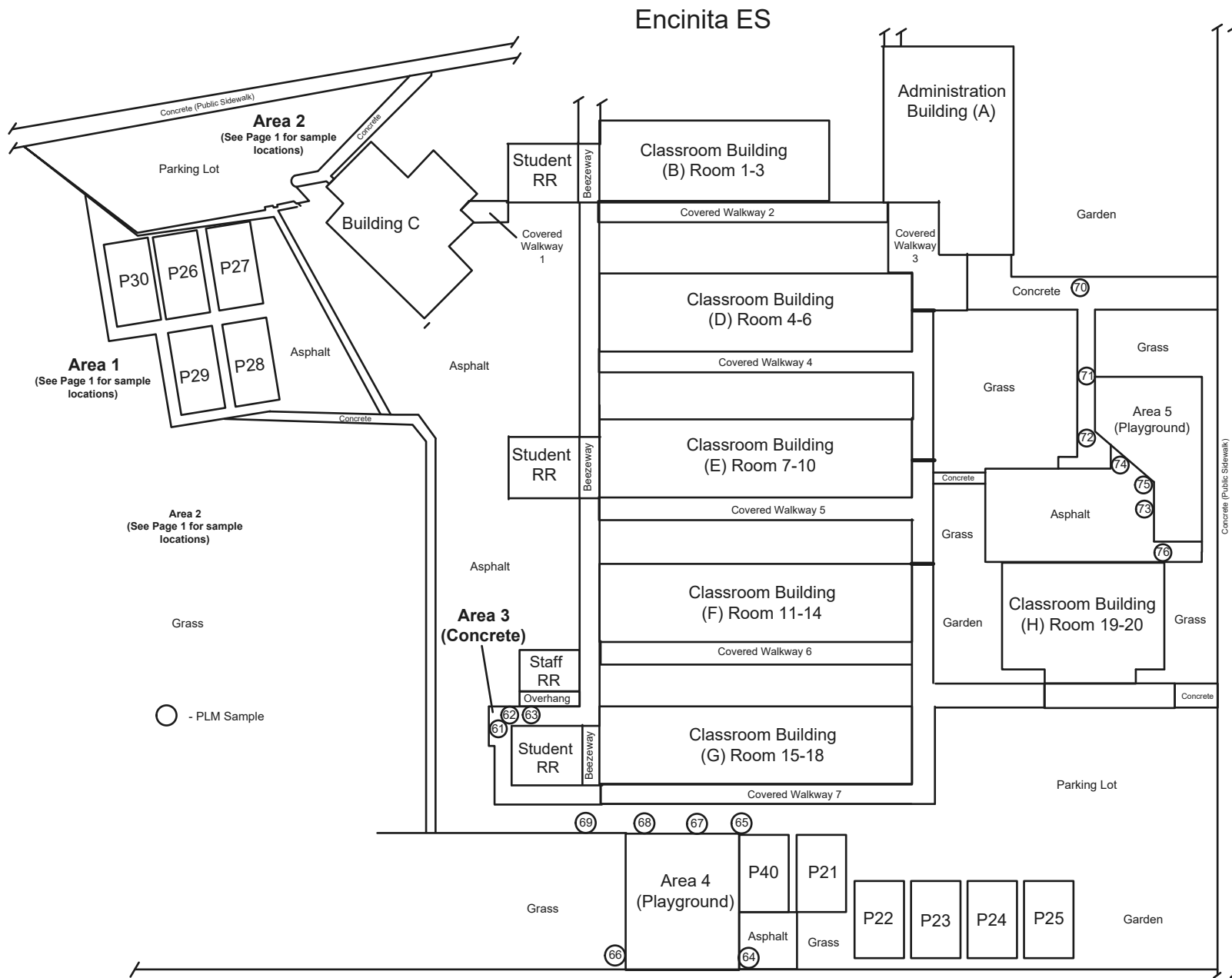

Client: Rosemead School District

Project #: 23-Z0046-0029

Info: PLM Sample Locations (Page 2 of 2)



EXECUTIVE ENVIRONMENTAL
HEALTH & SAFETY SIMPLIFIED

Site: Encinita Elementary School
Address: 4515 Encinita Avenue
 Rosemead, California 91770

Drawing Not to Scale - © 2012

APPENDIX C – STAFF CERTIFICATION

State of California
Division of Occupational Safety and Health
Certified Asbestos Consultant

Rhys D Kuzmic

Name



Certification No. **09-4586**

Expires on **01/20/21**

This certification was issued by the Division of Occupational Safety and Health as authorized by Sections 7180 et seq. of the Business and Professions Code.